TERREBONNE PARISH COUNCIL

PUBLIC SERVICES COMMITTEE

Mr. Alidore "Al"	
Marmande	Chairman
Mr. Gerald Michel	Vice-Chairman
Mr. John Navy	Member
Ms. Arlanda Williams	Member
Mr. Scotty Dryden	Member
Ms. Christa Duplantis-	Member
Prather	Member
Mr. Darrin W. Guidry,	Member
Sr.	Member
Mr. Dirk Guidry	
Mr. Steve Trosclair	



In accordance with the Americans with Disabilities Act, if you need special assistance, please contact Venita H. Chauvin, Council Clerk, at (985) 873-6519 describing the assistance that is necessary.

AGENDA

January 23, 2017
5:30 PM

Parish Council Meeting Room

NOTICE TO THE PUBLIC: If you wish to address the Council, please complete the "Public Wishing to Address the Council" form located on either end of the counter and give it to either the Chairman or the Council Clerk prior to the beginning of the meeting. Individuals addressing the council should be respectful of others in their choice of words and actions. Thank you.

ALL CELL PHONES, PAGERS AND ELECTRONIC DEVICES USED FOR COMMUNICATION SHOULD BE SILENCED FOR THE DURATION OF THE MEETING

INVOCATION

PLEDGE OF ALLEGIANCE

CALL MEETING TO ORDER

ROLL CALL

1. **RESOLUTION:** To authorize the Parish President to have the signing authority on the Louisiana Division of Administration, Facility Planning and Control (FP&C) capital projects.
2. Introducing an Ordinance authorizing the grant of one (1) permanent servitude to Entergy Louisiana, LLC on a portion of a parcel of land located in Cypress Village Resubdivision, Parcel #37164 and calling a public hearing on February 8, 2017, at 6:30 p.m.
3. **RESOLUTION:** Authorizing the execution of Change Order No. 3 to Parish Project 10-SEW-96; Ashland Wetland Assimilation Discharge System, for an increase in the contract price of \$17,117.15, and an increase of

281 calendar days.

4. RESOLUTION: Authorizing the execution of Change Order No. 5 (Balancing) for the Construcion Agreement for Parish Project No. 10-CDBG-R-LEV-63; Ward 7 Levee Improvements & Extension Phase I, Bayou Neuf to East Houma Surge Levee Project, Terrebonne Parish, Louisiana.
5. RESOLUTION Ratifying the appointment of the firm of All South Consulting Engineers, LLC to provide professional services for the Valhi Extension Line and Grade Study, Parish Project No. 17-ROAD-02; and authorizing the execution of an agreement for these services.
6. RESOLUTION: Ratifying the appointment of the firm of David A. Waitz Engineering and Surveying, Inc. to provide professional services for the Wauban Subdivision Drainage Project, Parish Project No. 17-DRA-03; and authorizing the execution of an agreement for these services.
7. RESOLUTION: Awarding and authorizing the signing of Construction Contract with Synagro South, LLC, in the amount of \$571,500.00, for South Plant Improvements, Parish Project No. 15-SEW-18.
8. RESOLUTION: Awarding and authorizing the signing of the construction contract for Parish Project No.16-SEW-44, East Coteau/Bayou Blue Sewer Holding Basin Dredging, Terrebonne Parish Consolidated Government, Terrebonne Parish, Louisiana, and authorizing the issuance of the Notice to Proceed.
9. RESOLUTION: Authorizing the execution of Change Order No. 9 for the Construction Agreement for Parish Project No. 14-EOC-03, Terrebonne Parish Emergency Operations Center, Terrebonne Parish, Louisiana
10. RESOLUTION: Ratifying the appointment of the firm of All South Consulting Engineers, LLC to provide professional services for the Sylvia Street Drainage Improvements Project Phase 3A, Project No. 17-DRA-04; and authorizing the execution of an agreement for these services.
11. RESOLUTION: Ratifying the appointment of the firm of Logan H. Babin Real Estate & Appraisals, to provide appraisal services for the Susie Canal Levee Improvements Project (CDBG); Parish Project No. 10-LEV-31 and authorizing execution of an agreement or Purchase Order for these services.
12. RESOLUTION: Providing approval of Amendment No. 1 to the Engineering Agreement for Parish Project No. **16-DRA-25, Petit Caillou Drainage Project**, Terrebonne Parish, Louisiana.
13. RESOLUTION: Providing approval of Amendment No. 1 to the Engineering Agreement for Parish Project No. **16-DRA-26, Chacahoula/Gibson Drainage Project**, Terrebonne Parish, Louisiana.
14. Adjourn

Category Number:
Item Number:



Monday, January 23, 2017

Item Title:

INVOCATION

Item Summary:

INVOCATION

Category Number:
Item Number:



Monday, January 23, 2017

Item Title:

PLEDGE OF ALLEGIANCE

Item Summary:

PLEDGE OF ALLEGIANCE

Category Number:
Item Number: 1.



Monday, January 23, 2017

Item Title:

Authorizing Parish President to sign FP&C documents

Item Summary:

RESOLUTION: To authorize the Parish President to have the signing authority on the Louisiana Division of Administration, Facility Planning and Control (FP&C) capital projects.

ATTACHMENTS:

Description	Upload Date	Type
Resolution	1/11/2017	Resolution
Executive Summary	1/11/2017	Executive Summary

OFFERED BY:
SECONDED BY:

RESOLUTION

A resolution to authorize the Parish President to have the signing authority on the Louisiana Division of Administration, Facility Planning and Control Capital Projects.

WHEREAS, the Terrebonne Parish Consolidated Government has numerous Cooperative Endeavor Agreements (CEA) with the State of Louisiana – Division of Administration, Facility Planning and Control (FP&C) on capital projects, and

WHEREAS, the Terrebonne Parish Council on behalf of the Terrebonne Parish Consolidated Government, does hereby authorize the Parish President, Gordon Dove, to have the signing authority on the capital projects with FP&C, and

WHEREAS, the capital projects include:

Bayou LaCarpe Watershed Project, Location C; 50-J55-14-02
Dredging of Bayou Terrebonne Project; 50-J55-14-04
Thompson Road Extension; 50-J55-08B-02
Upper Bayou Dularge Pump Station: 50-J55-12-01

NOW, THEREFORE BE IT RESOLVED that the Terrebonne Parish Council, on behalf of the Terrebonne Parish Consolidated Government, does hereby authorize the Parish President, Gordon Dove, to have signing authority on the above listed FP&C capital projects.

THERE WAS RECORDED:

YEAS:
NAYS:
NOT VOTING:
ABSENT

And the Chairman declared the resolution adopted on this _____ day of _____, 2017.

* * * * *

I, VENITA H CHAUVIN, Clerk of the Terrebonne Parish Council, do hereby certify that the foregoing is a true and correct copy of the resolution adopted by the Public Services Committee Meeting on _____, 2017 and subsequently ratified by the Assembled Council in Regular Session on _____, 2017 at which meeting a quorum was present.

GIVEN UNDER MY OFFICIAL SIGNATURE AND SEAL OF OFFICE THIS _____ DAY OF _____, 2017.

VENITA H CHAUVIN
COUNCIL CLERK
TERREBONNE PARISH COUNCIL



EXECUTIVE SUMMARY

(REQUIRED FOR ALL SUBMISSIONS)

PROJECT TITLE
Resolution authorizes Parish President to sign on FP&C capital projects

PROJECT SUMMARY (200 WORDS OR LESS)
Authorizing the Parish President to have the signing authority on capital projects with FP&C

PROJECT PURPOSE & BENEFITS (150 WORDS OR LESS)
The purpose of this resolution is to give the Parish President the authority to sign any and all documents pertaining to FP&C on capital projects.

TOTAL EXPENDITURE		
N/A		
AMOUNT SHOWN ABOVE IS: (CIRCLE ONE)		
<u>ACTUAL</u>	ESTIMATED	
IS PROJECTALREADY BUDGETED: (CIRCLE ONE)		
N/A	NO	<u>YES</u>
IF YES AMOUNT BUDGETED:		N/A

COUNCIL DISTRICT(S) IMPACTED (CIRCLE ONE)									
<u>PARISHWIDE</u>	1	2	3	4	5	6	7	8	9

Jeanne P. Bray

01/11/2017

Signature

Date



Monday, January 23, 2017

Item Title:

Ordinance granting a Servitude to Entergy Louisiana

Item Summary:

Introducing an Ordinance authorizing the grant of one (1) permanent servitude to Entergy Louisiana, LLC on a portion of a parcel of land located in Cypress Village Resubdivision, Parcel #37164 and calling a public hearing on February 8, 2017, at 6:30 p.m.

ATTACHMENTS:

Description	Upload Date	Type
Executive Summary	1/17/2017	Executive Summary
Backup Material	1/17/2017	Backup Material



EXECUTIVE SUMMARY

(REQUIRED FOR ALL SUBMISSIONS)

PROJECT TITLE

An Ordinance authorizing the grant of one (1) permanent servitude to Entergy Louisiana, LLC on a portion of a parcel of land located in Cypress Village Resubdivision, Parcel #37164.

PROJECT SUMMARY (200 WORDS OR LESS)

Entergy Louisiana, LLC is proposing to construct a new electric power line in the vicinity of Deadwood Road in which the electric power line will cross one (1) property partially owned by TPCG.

PROJECT PURPOSE & BENEFITS (150 WORDS OR LESS)

TPCG wishes to grant the servitude requested to accommodate said construction in recognition of the public benefit to be gained.

TOTAL EXPENDITURE

\$0.00

AMOUNT SHOWN ABOVE IS: (CIRCLE ONE)

ACTUAL

ESTIMATED

IS PROJECT ALREADY BUDGETED: (CIRCLE ONE)

N/A

NO

YES

IF YES AMOUNT
BUDGETED:

COUNCIL DISTRICT(S) IMPACTED (CIRCLE ONE)

PARISHWIDE

1

②

3

4

5

6

7

8

9

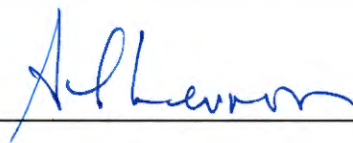

Signature

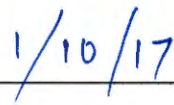

Date

OFFERED BY:
SECONDED BY:

ORDINANCE NO.

AN ORDINANCE AUTHORIZING THE GRANT OF ONE (1) PERMANENT SERVITUDE TO ENTERGY LOUISIANA, LLC ON A PORTION OF A PARCEL OF LAND LOCATED IN CYPRESS VILLAGE RESUBDIVISION, PARCEL #37164.

WHEREAS, Entergy Louisiana, LLC is proposing to construct a new electric power line in the vicinity of Deadwood Road, and

WHEREAS, the proposed routing of said electric power line will cross one (1) property partially owned by Terrebonne Parish Consolidated Government, and

WHEREAS, Terrebonne Parish Consolidated Government wishes to grant the servitude requested to accommodate said construction in recognition of the public benefit to be gained.

NOW THEREFORE BE IT ORDAINED, by the Terrebonne Parish Council, in regular session convened, that the grant of a permanent servitude to Entergy Louisiana LLC on Parcel # 37164 which the Parish holds a 45.5% ownership interest be, and is hereby, authorized by the Terrebonne Parish Council on behalf of the Terrebonne Parish Consolidated Government, and

BE IT FURTHER ORDAINED, that the Parish President is hereby authorized to execute any and all documents necessary to effect said grant, subject to review by the Parish Legal Department.



Rampart Resources Inc.
7915 Wrenwood Blvd.
Suite C
Baton Rouge, LA 70809

October 12, 2016

HAND DELIVERED

Terrebonne Parish Consolidated Government
P. O. Box 2768
Houma LA 70361

Re: Offer of Entergy Louisiana, LLC ("Entergy") For Acquisition of Transmission Line Servitude (Right-of-Way)

Dear Sir or Madam,

Entergy needs to obtain a personal servitude of right of use (right-of-way) over and across your property located in Terrebonne Parish, Louisiana for the purposes of locating, constructing, operating and maintaining electric power lines, circuits and/or communication facilities. The dimensions and location of the proposed servitude are more particularly described in the Right-of-Way Instrument and attached survey plat enclosed.

Entergy estimates the total compensation offer for the entire servitude to be \$3,061.30. The compensation offer was calculated using the price of recent land sales for similar properties located in the vicinity of your land. Based upon your undivided ownership interest in and to the subject property, your estimated share of the total compensation is \$1,392.89, and Entergy is offering to pay that amount to you in exchange for the requested servitude over your interest in the property.

For the sake of convenience in the event that you accept this offer, I have prepared and enclosed herewith for your review and approval three (3) duplicate copies of the Right-of-Way Instrument, an IRS Form W-9, instructions detailing the proper execution of the documents, and a self-addressed stamped envelope for your convenience.

Once the signed and notarized Right Of Way Instrument and the completed W-9 are returned to me at the address noted above, the amount of consideration for said servitude as set out above will be paid to you by Entergy Louisiana, LLC.

Entergy will be pleased to reimburse you for any reasonable Notary expense if you will simply include the receipt for this service.

If you have any questions concerning this offer, please contact me at the telephone number below. Entergy sincerely hopes that a mutually satisfactory agreement can be reached with regard to this matter.

Sincerely,

Michael A. Reesby

Rampart Resources Inc.

Right of Way Acquisition Agent for Entergy

225-892-4080

w/Enclosures

*Parcel # 376F
45.5% ownership*

Received and accepted this _____ day of _____, 2016

By: _____

(01/27/2005)

STATE OF LOUISIANA

Indexing Instructions: _____

PARISH OF TERREBONNE

Line/Project Identification: _____

RIGHT-OF-WAY INSTRUMENT
ENTERGY LOUISIANA, LLC

KNOW ALL MEN BY THESE PRESENTS THAT: **Terrebonne Parish Consolidated Government**, a public corporation and political subdivision domiciled in the Parish of Terrebonne, State of Louisiana, created, organized and existing under the laws of the State of Louisiana, represented herein by its duly authorized and empowered _____, whose mailing address is P. O. Box 2768, Houma LA 70361 (referred to collectively, whether one or more, as "Grantor") for and in consideration of One Dollar and other valuable consideration, in hand paid to Grantor, and other good and valuable consideration, the receipt and sufficiency of which is hereby acknowledged, does hereby grant, bargain, sell, transfer, assign, and convey unto, **Entergy Louisiana, LLC**, a Louisiana Limited Liability Company and its successors and assigns (collectively "Grantee"), a right-of-way, servitude and easement of **0.253 acres** for the location, relocation, improvements, repair, construction, reconstruction, operation, inspection, patrol, replacement, removal and maintenance of one or more electric power lines, circuit or circuits and/or communication facilities (to be used for operation of Grantee's utility system), now or in the future, including, but not necessarily limited to, poles, towers, cross arms, insulators, wires, cables, conduits, hardware, transformers, switches, guy wires, anchors and other equipment, structures, material and appurtenances, now or hereafter used, useful or desired in connection therewith by Grantee (hereinafter "Grantee's facilities") over, across, under or on that land of Grantor in the Parish of Terrebonne, State of Louisiana described as follows, to-wit:

That certain tract or parcel of land, located in Section 6, Township 16 South, Range 14 East, Terrebonne Parish, Louisiana, being all of Lot "C" and a portion of Lot "B" of Cypress Village - Resubdivision of Lots 1, 2, 3 & 4, as shown and designated on that certain plat recorded in COB 535, Page 883, File No. 420543, and being more particularly described in that certain Cash Sale recorded in COB 816, Page 126, File No. 638817 of the records of Terrebonne Parish, Louisiana; said right-of-way, servitude and easement being more particularly described and shown on Exhibit "A" and Exhibit "B" attached hereto and made a part hereof.

Grantor hereby grants to Grantee the rights of ingress and egress, as reasonably necessary and in a reasonable manner, at any time, without notice, to, from, or along said right-of-way across the adjoining land of the Grantor, including, but not limited to, the passage of vehicles and equipment upon said right-of-way; the right to install, extend and maintain guy wires and anchors beyond the limits of said right-of-way under emergency circumstances, which guy wires and anchors shall be removed by Grantee as soon as practicable.

Grantee shall have the full and continuing right, without further compensation, to clear and keep clear vegetation within or growing into said right-of-way and the further right to remove or modify from time to time trees, limbs, and/or vegetation outside the said right of way which Grantee considers a risk to any of Grantee's facilities or a risk to the rendering of adequate and dependable service to Grantor or any of Grantee's customers, by use of a variety of methods used in the vegetation management industry. As used in this paragraph, "risk" includes any trees, limbs, and/or vegetation that Grantee determines are tall enough that if they fell may strike, hit, or come in contact with any of Grantee's facilities. Grantee shall pay to Grantor, or Grantor's successor in title, the reasonable market value, as timber, of such trees when removed outside of the said right-of-way.

Grantee shall pay Grantor for physical damages 1) to Grantor's buildings or other structures located outside said right-of-way and 2) to Grantor's growing annual crops, road, bridges and fences where such physical damage is caused by the construction and/or maintenance of Grantee's facilities.

Grantor retains the right to use for Grantor's own purposes the land covered by the said right-of-way so long as such use does not interfere with Grantee's use of said right-of-way and other rights herein granted.

Grantor shall not construct or permit the construction of any structure, obstruction or other hazard within the said right-of-way, including but not limited to, any house, barn, garage, shed, pond, pool, water impoundment, excavation or well, excepting only Grantor's fence(s) and Grantee's facilities. Grantor shall not construct or permit the construction of any buildings or other structures on land adjoining said right-of-way in violation of the minimum clearances from the lines and facilities of Grantee, as provided in the National Electrical Safety Code.

This Right of Way Instrument may be executed in multiple parts where there are multiple owners, each of which such multiple part shall be binding on the party or parties so executing.

IN WITNESS WHEREOF, Grantor has executed this Right-of-Way Instrument on this ____ day of _____, 2016.

WITNESSES:

Print Name _____

Print Name _____

GRANTOR:

Terrebonne Parish Consolidated Government

x _____
By:
Title:

WITNESS ACKNOWLEDGMENT

STATE OF LOUISIANA

PARISH OF EAST BATON ROUGE

BEFORE ME, the undersigned Notary Public, on this ____ day of _____, 2016, personally appeared **Michael A. Reesby**, who, being by me duly sworn, stated under oath that he was one of the subscribing witnesses to the foregoing instrument and that the same was signed by _____, as duly authorized and empowered representative of **Terrebonne Parish Consolidated Government** (Grantor), as above mentioned in his presence and in the presence of the other subscribing witness.

SUBSCRIBING WITNESS

X _____

Michael A. Reesby

NOTARY PUBLIC

X _____

EXHIBIT "A"
11,033 SQUARE FEET OR 0.253 ACRE

BEING A 50 FOOT WIDE EASEMENT AND HAVING 0.253 ACRE SITUATED IN SECTION 6, TOWNSHIP 16 SOUTH, RANGE 14 EAST OF THE LOUISIANA MERIDIAN, TERREBONNE PARISH, LOUISIANA AND BEING PART OF A TRACT OF LAND DESCRIBED AS LOT C AND PORTION OF LOT B OF CYPRESS VILLAGE – RESUBDIVISION OF LOTS 1, 2, 3 AND 4, IN DEED TO JOSEPH AND LINDA CHERAMIE, RECORDED IN BOOK 2381, PAGE 253, CONVEYANCE RECORDS, TERREBONNE PARISH, LOUISIANA (C.R.T.P.L.), IN DEED TO LIONEL RUFFIN, RECORDED IN BOOK 1693, PAGE 707, C.R.T.P.L., AND IN DEED TO TERREBONNE PARISH CONSOLIDATED GOVERNMENT, RECORDED IN BOOK 1873, PAGE 647, C.R.T.P.L., AND BEING MORE PARTICULARLY DESCRIBED AS FOLLOWS:

BEGINNING AT A POINT IN THE COMMON LINE OF SAID CHERAMIE TRACT AND A TRACT OF LAND DESCRIBED IN DEED TO PAPA'S OLD HOUSE, L.L.C., RECORDED IN BOOK 2299, PAGE 593, C.R.T.P.L., AND BEING 50 FEET SOUTH WHEN MEASURED PERPENDICULAR, TO THE SOUTH LINE OF A LOUISIANA POWER AND LIGHT COMPANY 100 FOOT RIGHT-OF-WAY (AS EXIST), RECORDED IN BOOK 255, PAGE 1, C.R.T.P.L., FROM WHICH A NGS CONCRETE MONUMENT DESIGNATION – DOKKA FOUND BEARS SOUTH 68 DEGREES 57 MINUTES 55 SECONDS EAST, A DISTANCE OF 2,342.48 FEET, SAID POINT OF BEGINNING HAVING GRID COORDINATES OF N:433287.03, E:3387240.58;

THENCE SOUTH 59 DEGREES 20 MINUTES 11 SECONDS WEST, LEAVING THE COMMON LINE OF SAID CHERAMIE TRACT AND SAID PAPA'S OLD HOUSE, L.L.C. TRACT, AND BEING 50 FEET SOUTH WHEN MEASURED PERPENDICULAR, AND PARALLEL TO THE SOUTH LINE OF SAID LOUISIANA POWER AND LIGHT COMPANY 100 FOOT RIGHT-OF-WAY, A DISTANCE OF 218.53 FEET TO A POINT FOR CORNER AT THE BEGINNING OF A NON-TANGENT CURVE TO THE RIGHT HAVING A CENTRAL ANGLE OF 02 DEGREES 34 MINUTES 27 SECONDS, A RADIUS OF 1,207.83 FEET AND A CHORD BEARING AND DISTANCE OF NORTH 07 DEGREES 48 MINUTES 09 SECONDS WEST, 54.26 FEET, IN THE EAST OF DEADWOOD ROAD, FROM WHICH A NGS CONCRETE MONUMENT DESIGNATION - T 298 FOUND BEARS SOUTH 36 DEGREES 38 MINUTES 02 SECONDS WEST, A DISTANCE OF 4,397.14 FEET;

THENCE NORTHERLY, ALONG SAID CURVE TO THE RIGHT, AN ARC DISTANCE OF 54.27 FEET TO A POINT FOR CORNER IN THE SOUTH LINE OF SAID LOUISIANA POWER AND LIGHT COMPANY 100 FOOT RIGHT-OF-WAY;

THENCE NORTH 59 DEGREES 20 MINUTES 11 SECONDS EAST, LEAVING SAID CURVE TO THE RIGHT, AND ALONG THE SOUTH LINE OF SAID LOUISIANA POWER AND LIGHT COMPANY 100 FOOT RIGHT-OF-WAY, A DISTANCE OF 222.39 FEET TO A POINT FOR CORNER IN THE COMMON LINE OF SAID CHERAMIE TRACT AND SAID PAPA'S OLD HOUSE, L.L.C. TRACT;

THENCE SOUTH 04 DEGREES 07 MINUTES 50 SECONDS EAST, LEAVING THE SOUTH LINE OF SAID LOUISIANA POWER AND LIGHT COMPANY 100 FOOT RIGHT-OF-WAY, AND ALONG THE COMMON LINE OF SAID CHERAMIE TRACT AND SAID PAPA'S OLD HOUSE, L.L.C. TRACT, A DISTANCE OF 49.08 FEET TO A POINT FOR CORNER AT THE BEGINNING OF A CURVE TO THE LEFT HAVING A CENTRAL ANGLE OF 00 DEGREES 23 MINUTES 10 SECONDS, A RADIUS OF 1,007.82 FEET AND A CHORD BEARING AND DISTANCE OF SOUTH 04 DEGREES 19 MINUTES 25 SECONDS EAST, 6.79 FEET;

ENTERGY LOUISIANA, L.L.C.
TERREBONNE TO BAYOU VISTA TRANSMISSION LINE EASEMENT
50' WIDE EASEMENT
JOSEPH AND LINDA CHERAMIE TRACT - LA_TER_118A

SAM Job No. 36256
Page 2 of 3

EXHIBIT "A"

THENCE SOUTHERLY, CONTINUING ALONG THE COMMON LINE OF SAID CHERAMIE TRACT AND SAID PAPA'S OLD HOUSE, L.L.C. TRACT, AND ALONG SAID CURVE TO THE LEFT, AN ARC DISTANCE OF 6.79 FEET TO THE **POINT OF BEGINNING** AND CONTAINING 11,033 SQUARE FEET OR 0.253 OF AN ACRE OF LAND, MORE OR LESS.

BEARING BASIS: ALL BEARINGS AND COORDINATES SHOWN HEREON ARE BASED ON THE LOUISIANA STATE PLANE COORDINATE SYSTEM, NAD 83(2011), SOUTHERN ZONE (1702). DISTANCES ARE SURFACE VALUES IN U.S. SURVEY FEET. GRID DISTANCES CAN BE CALCULATED BY APPLYING A COMBINED SCALE FACTOR (CSF) OF 0.999947399.

REFERENCE IS MADE TO THE SKETCH OF EVEN DATE ACCOMPANYING THIS DESCRIPTION.

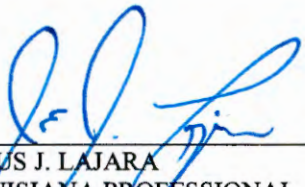

JESUS J. LAJARA
LOUISIANA PROFESSIONAL
LAND SURVEYOR NO. 5041
SURVEYING AND MAPPING, LLC.
LOUISIANA FIRM REGISTRATION NO. VF.0000618

07/25/2016



DATE: JULY 25, 2016

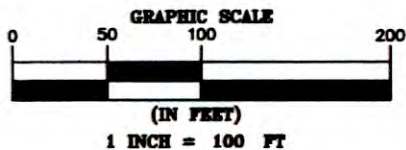

EXHIBIT "B"

CURVE TABLE C2	
DELTA ANGLE	2°34'27"
RADIUS	1207.83'
LENGTH	54.27'
CHORD BEARING	N07°48'09"W
CHORD LENGTH	54.26'

CURVE TABLE C5	
DELTA ANGLE	0°23'10"
RADIUS	1007.82'
LENGTH	6.79'
CHORD BEARING	S04°19'25"E
CHORD LENGTH	6.79'

JOSEPH AND LINDA CHERAMIE
BOOK 2381, PAGE 253
C.R.T.P.L.
LIONEL RUFFIN
BOOK 1693, PAGE 707
C.R.T.P.L.
TERREBONNE PARISH
CONSOLIDATED GOVERNMENT
BOOK 1873, PAGE 647
C.R.T.P.L.
LOT C AND PORTION OF LOT B
LA_TER_118A

PAPA'S OLD HOUSE, L.L.C.
BOOK 2299, PAGE 593
C.R.T.P.L.
LA_TER_118A

DEADWOOD RD

LOT "B"

LOUISIANA POWER AND
LIGHT COMPANY
BOOK 255, PAGE 1
C.R.T.P.L.
100' WIDE RIGHT-OF-WAY
(AS EXIST)

P.O.B.
GRID COORDINATES:
N:433287.03
E:3387240.58

S68°57'55"E 2342.48'
P.O.R. - NGS CONCRETE MONUMENT
DESIGNATION - DOKKA FOUND

PROPOSED 50'
WIDE EASEMENT
0.253 ACRES
(11,033 S.F.)

SECTION 6
TOWNSHIP 16 SOUTH
RANGE 14 EAST
TERREBONNE PARISH,
LA

DETAIL "A"

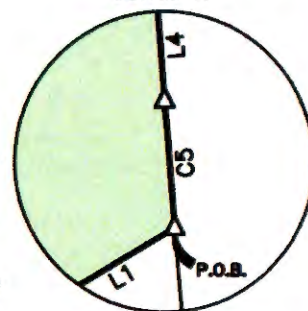

(NOT TO SCALE)

LEGEND

C.R.T.P.L. CONVEYANCE RECORDS
TERREBONNE PARISH, LOUISIANA
P.O.B. POINT OF BEGINNING
P.O.R. POINT OF REFERENCE
△ CALCULATED POINT
--- APPROXIMATE LOCATION OF SURVEY LINE
--- PROPOSED EASEMENT CENTERLINE
--- PROPOSED EASEMENT
--- TRACT LINE

SURVEY NOTES:

1. BASIS OF BEARINGS IS THE LOUISIANA STATE PLANE COORDINATE SYSTEM, NAD 83 (2011), SOUTHERN ZONE (1702). DISTANCES AND COORDINATES ARE SURFACE VALUES IN U.S. SURVEY FEET. TO CONVERT TO GRID VALUES, MULTIPLY SURFACE DISTANCES BY A COMBINED SCALE FACTOR OF 0.999947399.

2. THIS EXHIBIT DOES NOT REFLECT ANY UNDERGROUND UTILITIES, EASEMENT OF RECORD OR OTHER ENCUMBRANCES THAT MAY AFFECT THE SUBJECT TRACT.

3. REFERENCE IS MADE TO THE DESCRIPTION OF EVEN DATE ACCOMPANYING THIS SKETCH.

4. THIS EXHIBIT IS NOT A BOUNDARY SURVEY.

I, JESUS J. LAJARA, PROFESSIONAL LAND SURVEYOR IN THE STATE OF LOUISIANA HEREBY CERTIFY THAT THIS SURVEY WAS DONE UNDER MY DIRECT SUPERVISION IN ACCORDANCE WITH THE STANDARDS OF PRACTICE FOR BOUNDARY SURVEYS, CHAPTER 29 OF TITLE 46, PART LXI OF THE LOUISIANA ADMINISTRATIVE CODE AND IN ACCORDANCE WITH A CLASS "D" SURVEYS, AS INDICATED IN THE ABOVE MENTIONED STANDARDS.

LINE TABLE		
NUMBER	BEARING	DISTANCE
L1	S59°20'11"W	218.53'
L3	N59°20'11"E	222.39'
L4	S04°07'50"E	49.08'



JESUS J. LAJARA
LOUISIANA PROFESSIONAL LAND
SURVEYOR NO. 5041
LOUISIANA FIRM NO. VF.0000618

SHEET 03 OF 03

PROJECT: TERREBONNE
JOB NUMBER: 36256
DATE: 07/25/2016
SCALE: 1"=100'
PARCEL ID: LA_TER_118A
DRAWN BY: RA

ENTERGY LOUISIANA, L.L.C.
TERREBONNE TO BAYOU VISTA
TRANSMISSION LINE EASEMENT ACROSS THE LAND OF
JOSEPH AND LINDA CHERAMIE
SECTION 6, TOWNSHIP 16 SOUTH, RANGE 14 EAST
LOUISIANA MERIDIAN, TERREBONNE PARISH, LOUISIANA



7101 Envoy Court, Dallas, Tx 75247
Ph: (214) 631-7888 Fax: (214) 631-7103
EMAIL: SAM@SAM.BIZ



Monday, January 23, 2017

Item Title:

Change Order No. 3 to Parish Project No. 10-SEW-96; Ashland Wetland Assimilation Discharge System

Item Summary:

RESOLUTION: Authorizing the execution of Change Order No. 3 to Parish Project 10-SEW-96; Ashland Wetland Assimilation Discharge System, for an increase in the contract price of \$17,117.15, and an increase of 281 calendar days.

ATTACHMENTS:

Description	Upload Date	Type
Resolution	1/17/2017	Resolution
Change Order No. 3	1/17/2017	Backup Material
Executive Summary	1/17/2017	Executive Summary

OFFERED BY:
SECONDED BY:

RESOLUTION NO. _____

A Resolution authorizing the execution of Change Order No. 3 to the Construction Agreement for Parish Project No. 10-SEW-96, Ashland Wetland Assimilation Discharge System Project, CWSRF Contract No. 221492-01, contingent upon the approval of the Louisiana Department of Environmental Quality (LA DEQ).

WHEREAS, the Terrebonne Parish Consolidated Government did enter into a Construction Agreement with Cycle Construction Company, LLC, dated August 18, 2015, Recordation Number 1487686, for Parish Project No. 10-SEW-96, Ashland Wetland Assimilation Discharge System Project, CWSRF Contract No. 221492-01, Terrebonne Parish, Louisiana, and

WHEREAS, Providence Engineering and Design, LLC, the Project Engineer has recommended this Change Order No. 3, for: 1) Fill Material, 2) Discharge Header No. 4 Support Structure, 3) Removal of concrete footing on existing wetwell, and 4) Pressure testing of sewer discharge line will not be required. This Change Order No. 3 will also increase the contract time by 281 calendar days for flooding and pump station delay, additional fill, discharge for support and removal of wetwell footing, and

WHEREAS, this Change Order will increase the contract price, in the amount of \$17,117.15, with an increase of 281 calendar days.

NOW THEREFORE BE IT RESOLVED, by the Terrebonne Parish Council (Public Services Committee), on behalf of the Terrebonne Parish Consolidated Government, does hereby approve this Change Order No. 3 to the Construction Agreement for an increase of \$17,117.15 and authorizes Parish President Gordon E. Dove to execute this Change Order No. 3 to the Construction Agreement for the Ashland Wetland Assimilation Discharge System Project, Parish Project No. 10-SEW-96, CWSRF Contract No. 221492-01, and

BE IT FURTHER RESOLVED that a certified copy of the resolution be forwarded to the Engineer, Providence Engineering and Design, LLC.

THERE WAS RECORDED:
YEAS:
NAYS:
NOT VOTING:
ABSENT:

The Chairman declared this resolution adopted this _____ day of _____, 2017.

* * * * *

I, VENITA H. CHAUVIN, Council Clerk of Terrebonne Parish Council, do hereby certify that the foregoing is a true and correct copy of a resolution adopted by the Public Services Committee on _____, 2017 and subsequently ratified by the Assembled Council in Regular Session on _____, 2017, at which meeting a quorum was present.

GIVEN UNDER MY OFFICIAL SIGNATURE AND SEAL OF OFFICE THIS _____ DAY OF _____, 2017.

VENITA H. CHAUVIN
COUNCIL CLERK
TERREBONNE PARISH COUNCIL

CHANGE ORDER

Dated December 15, 2016

OWNER's Project No. 10-SEW-96

ENGINEER's Project No. 441-044-GSE

Ashland Wetland Assimilation
CWSRF Contract No. 221492-01

Project: Terrebonne Parish, Louisiana

CONTRACTOR Cycle Construction Company, LLC

Contract For Wetland Assimilation

Contract Date August 18, 2015

To: Cycle Construction Company, LLC

CONTRACTOR

You are directed to make the changes noted below in the subject Contract:

Terrebonne Parish Consolidated Government
OWNER

By Gordon E. Dove, Parish President

Dated _____, 2017

Nature of the Changes:

- | | | |
|--|------------------------------|-----------------|
| 1) Add Item X-3: Fill Material. | 150 C.Y. @ \$29.46 C.Y. = \$ | 4,419.00 |
| 2) Add Item X-4: Discharge Header No. 4 Support Structure. | Lump Sum = \$ | 8,173.52 |
| 3) Add Item X-5: Remove concrete footing on existing wetwell. | Lump Sum = \$ | <u>4,524.63</u> |
| | Total Addition = \$ | 17,117.15 |
| 4) Add contract time: 179 days for flooding and pump station delay, 15 days additional fill, 83 days discharge for support, and 4 days remove wetwell footing. | | |
| 5) Pressure testing of sewer discharge line will not be required. | | |

Enclosures:

Providence letter dated December 13, 2016.

Cost Breakdown's dated December 2, 2016 and December 14, 2016.

These changes result in the following adjustment of Contract Price and Contract Time:

Contract Price Prior to This Change Order \$ 1,760,135.90

Net (Increase) (~~Decrease~~) Resulting from this Change Order \$ 17,117.15

Current Contract Price Including This Change Order	\$ 1,777,253.05
--	-----------------

Contract Time Prior to This Change Order 283 Calendar Days – June 16, 2016
(Days or Date)

Net (Increase) (~~Decrease~~) Resulting from This Change Order 281 Calendar Days
(Days)

Current Contract Time Including This Change Order 564 Calendar Days – March 24, 2017
(Days or Date)

The Above Changes Are Approved: Providence Engineering and Design, LLC
ENGINEER

By Marie B. Cailland

Dated December 15, 2016

Contractor acknowledges that the values set forth in this change order include any and all claims for additional compensation due to equitable adjustment resulting from any change in contract time as a result of this change order.

The Above Changes Are Accepted: Cycle Construction Company, LLC
CONTRACTOR

By [Signature]

Dated 1/6/17, 2016



P: 504.467.1444
F: 504.467.1222

6 East Third Street
Kenner, LA 70062

December 14, 2016

Providence/GSE Engineers
991 Grand Caillou Rd.
Houma, LA 70363

Attn: Melanie Caillouet

**RE: Ashland Wetland Assimilation
Pipe Support at DP-4**

Dear Ms. Caillouet:

Cycle Construction Co., LLC (Cycle) hereby re-submits a price for the work associated with Installing a Pipe Support for Discharge Point 4 on the Ashland Wetland Assimilation Project. Please see the attached breakdown and relevant backup documents.

Our proposal was originally submitted on October 21 for this work. We received feedback and sent a revised price on October 28. Attached is the revised proposal and email chain showing the correspondence on the pricing.

We request that 55 calendar days be added to the contract for the time of submission through December 14, an additional 14 days for approval, and an additional 14 days to procure material and perform the work. The total is 83 calendar days requested.

We are available to meet at your earliest convenience to discuss this matter. Should you need any further information on this matter, please don't hesitate to call.

Sincerely,
Cycle Construction Co., LLC

A handwritten signature in black ink, appearing to read 'Mitchell Roth'.

Mitchell Roth
Project Manager

Ashland Support for DP-4

Price Breakdown

- Install Support for Discharge Point 4

Bid Qty: 1.00 LS

Labor

Description	Qty	Units	Rate	%	Total
Operator (Heavy)	18.00	MH	\$ 21.26	105.56	\$ 403.96
Operator (Light)	18.00	MH	\$ 17.00	105.56	\$ 323.01
Common Laborer	18.00	MH	\$ 12.00	105.56	\$ 228.01
Civil Superintendent	18.00	MH	\$ 40.00	105.56	\$ 760.03
Truck Driver	4.00	MH	\$ 28.00	105.56	\$ 118.23
					<hr/>
Labor Subtotal					\$ 1,833.24
26% Labor Burden					\$ 468.74
Fringes					\$ 441.34
Per Diem					\$ 633.33
					<hr/>
Total Labor Cost					\$ 3,377.65

78.00 MH

Equipment

Description	Qty	Units	Rate	%	Total
Hyundai 145 Excavator	18.00	HR	\$ 39.91	100.00	\$ 718.38
LD-Skid Steer (TL 150/CAT 27	18.00	HR	\$ 24.06	100.00	\$ 433.14
Pickup (1/2 TON) (Allowance)	18.00	HR	\$ 9.06	100.00	\$ 163.13
Lowboy & Truck (50 TON) (w/o	4.00	HR	\$ 46.56	100.00	\$ 186.25
					<hr/>
Total Equipment Cost					\$ 1,500.90

58.00 HR

Material

Description	Qty	Units	Rate	%	Total
3/4" x 20" Hex Bolts	4.00	EA	\$ 39.70	100.00	\$ 158.80
3x8x8 Treated Cross Timber	2.00	EA	\$ 23.20	100.00	\$ 46.40
1 1/4" x 8FT All Thread Rod	4.00	EA	\$ 78.25	100.00	\$ 313.00
24" Blind Flange	1.00	EA	\$ 1,385.65	100.00	\$ 1,385.65
1-1/4" Nuts Galv.	12.00	EA	\$ 1.55	100.00	\$ 18.60
20 FT Timber Pile 8"-6"	2.00	EA	\$ 105.00	100.00	\$ 210.00
1-1/4" Galv Flat Washer	12.00	EA	\$ 0.70	100.00	\$ 8.40
					<hr/>
Total Material Cost					\$ 2,140.85

Total Material Cost \$ 2,140.85

Total Item Cost \$ 7,019.40

Item Overhead, Bond, & Markup \$ 1,154.12

Item Price \$ 8,173.52

Item Unit Price \$8,173.52/LS

Melanie B. Caillouet, PE

From: Mitchell Roth <mroth@cycleconstruction.com>
Sent: Friday, October 21, 2016 7:34 PM
To: Melanie B. Caillouet, PE
Subject: RE: STP
Attachments: RFC-013 Install Support for Discharge Point 4.pdf; RFC-014 Install Culvert on ATV Trail.pdf

Melanie,

Attached are two proposals. One for supporting the discharge pipe and one for installing the culvert. I can follow up with formal letters if these are acceptable.

For supporting the pipe, I priced it using the all thread method that I mentioned below. A brief summary is as follows:

- Install 2 EA 30 FT piles as deep as we can by pushing them in with an excavator
- Bolt 2 EA 3x8x8 timbers horizontally to the piles
- Use a 24" blind flange across the top of the horizontal timbers and run 4 EA- 1 1/4" all threads down to the flange with the stainless steel screen on it. (We'll have to drill 4 bolt holes in the edge of the screen because it only has 4 bolt holes.
- (Using this method, we won't have to try to dam off the water. We should only have to uncover the top of the pipe to try to level it off as much as possible. We will have to be careful on how much pressure we put on it though. We don't want to break a flange or valve.)

Culvert installation on ATV trail summary:

- Install 36" A2000 pipe (we have a 12 FT piece in our yard)
- We will need to set the pipe in the ditch with an excavator then bring backfill dirt to it with the skid steer.

Please review and let me know if you need anything else or have any other suggestions.

Thanks,
Mitch

From: Mitchell Roth
Sent: Friday, October 21, 2016 11:06 AM
To: Melanie B. Caillouet, PE
Cc: Clay Breaud
Subject: Re: STP

Thought of a little bit quicker method. The stainless steel screens only use 4 bolt holes on the top flange of the discharge. We could use a couple of all thread rods bolted to that flange and up through the support timber. This would eliminate having to fabricate the plate and all thread is readily available. I could get the material on site early next week. Will this method work in your opinion?

Sent from my iPhone

On Oct 21, 2016, at 10:37 AM, Melanie B. Caillouet, PE <melaniecaillouet@providenceeng.com> wrote:



P: 504.467.1444
F: 504.467.1222

6 East Third Street
Kenner, LA 70062

December 2, 2016

Providence/GSE Engineers
991 Grand Caillou Rd.
Houma, LA 70363

Attn: Richard L. Lottinger

**RE: Parish Project No. 10-SEW-96
Ashland Wetland Assimilation
CWSRF Contract No. 221492-01
Terrebonne Parish, Louisiana**

Dear Mr. Lottinger:

We are in receipt of your letter regarding the contract time as well as some of the outstanding items on the above referenced project. This letter is in response to the items mentioned:

1. Pressure testing of pipe: It is our position that it is not possible to successfully test this pipe because the air can't be removed. We have made multiple attempts to flush and pressure test the discharge pipe. The pipe was installed with a uniform 3 FT of cover as per the plans. The elevation of existing grade varies along the route of the discharge pipe which caused high and low points in the pipe where air is getting trapped. We have flushed the pipe with portable pumps, the pump station flushed the line with the discharged pumps, and the system has been allowed to gravity flow. None of these methods have been able to remove the air pockets from the pipe. Additionally, no leaks were ever noticed during the flushing activities.

Please provide direction as to how the owner would like us to proceed. If the decision is made to perform additional gravity flow of the system and then to attempt another test, we will need to know when the discharge of water can begin. We were told on site, on 11/18/16, that the fecal levels were too high in the pond to discharge the water into the wetlands. We have not received an update yet on the results of any water quality testing.

2. A price to add dirt near discharge header no. 4: Please see attached proposal letter and breakdown.
3. A price to repair/replace the culvert on construction access road: Please see attached proposal letter and breakdown.
4. Calibration of flow meter: Please advise as to what further calibration is necessary. The Spectrum Group has been to the site to perform the calibrations. When we met on site on 11/8/16, it was our understanding that the flow meter wasn't reading

correctly due to the water level in the weir box being too high, not due to a calibration issue.

5. Possible adjustment of the discharge header elevations: Please provide direction as to what needs to be done. At the 11/8/16 meeting there was no resolution provided.
6. As-built drawings: We have record drawings with field notes at our office. They will be reproduced and submitted with the closeout documentation.
7. Construct discharge header no. 4 support structure upon approval of change order: We will proceed with this support when directed to do so.

Contract Time: Please see attached letter regarding the contract time. Additionally, as stated on the contract time letter, we feel like the work involved in the original scope has been substantially completed. We ask that the contract time be stopped.

Additional Items: We have the following items, not mentioned above, that we would like to submit in an attempt to help close the project out.

1. Sawcut and Remove Wetwell Top - Please see attached letter and proposal
2. Electrical Repairs - Please see attached letter and proposal
3. Assumed Leak at Weir Box - Please see attached letter and proposal

We are available to meet at your earliest convenience to discuss this matter. Should you need any further information on this matter, please don't hesitate to call.

Sincerely,
Cycle Construction Co., LLC

Mitchell Roth
Project Manager



P: 504.467.1444
F: 504.467.1222

6 East Third Street
Kenner, LA 70062

December 2, 2016

Providence/GSE Engineers
991 Grand Caillou Rd.
Houma, LA 70363

Attn: Melanie Caillouet

**RE: Ashland Wetland Assimilation
Fill Dirt for Access Road**

Dear Ms. Caillouet:

Cycle Construction Co., LLC (Cycle) hereby submits a price for the work associated with Installing Fill Dirt on the Access Road on the Ashland Wetland Assimilation Project. Please see the attached breakdown and relevant backup documents.

The attached proposal includes supplying and installing 150 cubic yards of fill dirt on the access road near Discharge Point 4 as requested. This quantity of fill material will be enough to install a 6" lift on an approximate area 500 LF long x 12 FT wide. 500 LF would cover from the 90 degree bend in the discharge pipe to the West edge of the old oil well field (where the road meets the field). If additional areas are required to be filled, we propose to supply and install the fill dirt for \$29.46 per cubic yard based on truck delivery tickets.

Additionally, we request 15 calendar days be added to the contract for review and installation of the material.

We are available to meet at your earliest convenience to discuss this matter. Should you need any further information on this matter, please don't hesitate to call.

Sincerely,
Cycle Construction Co., LLC

Mitchell Roth
Project Manager

Ashland RFC-016 Fill Dirt for Access Rd

Price Breakdown

- Install Fill Dirt on Access Road

Bid Qty: 1.00 LS

Labor

Description	Qty	Units		Rate	%		Total
Operator (Heavy)	9.00	MH	\$	21.26	105.56	\$	201.98
Common Laborer	9.00	MH	\$	12.00	105.56	\$	114.00
Civil Superintendent	9.00	MH	\$	40.00	105.56	\$	380.02
Truck Driver	4.00	MH	\$	28.00	105.56	\$	118.23
Labor Subtotal							\$ 814.23
26% Labor Burden							\$ 208.85
Fringes							\$ 181.96
Per Diem							\$ 258.33
Total Labor Cost							\$ 1,463.37

Equipment

Description	Qty	Units		Rate	%		Total
DZ-CAT D5 K (90 HP)	9.00	HR	\$	46.32	100.00	\$	416.89
Pickup (1/2 TON) (Company Ow	9.00	HR	\$	9.06	100.00	\$	81.57
Lowboy & Truck (50 TON) (w/o	4.00	HR	\$	46.56	100.00	\$	186.25
Total Equipment Cost							\$ 684.71

Material

Description	Qty	Units		Rate	%		Total
Fill Dirt Delivered	150.00	CY	\$	11.00	100.00	\$	1,650.00
Total Material Cost							\$ 1,650.00

Total Item Cost	\$	3,798.08
Item Overhead, Bond, & Markup	\$	620.79
Item Price	\$	4,418.87
Item Unit Price		\$4,418.87/LS



P: 504.467.1444
F: 504.467.1222

6 East Third Street
Kenner, LA 70062

December 2, 2016

**Providence/GSE Associates
991 Grand Caillou Road
Houma, LA 70363**

Attn: Melanie Caillouet

**RE: Ashland Wetland Assimilation
Additional Contract Time Request due to Flooding of Oil Well Site and
Pump Station Delays**

Mrs. Caillouet:

Cycle Construction Company, LLC respectfully requests consideration for additional contract time on the Ashland Wetland Assimilation project due to flooding of the private land side of the project and delays on the pump station side.

The oil well site on the private land side of the project has remained flooded from June through November. We have come to realize that the flooding is a combination of precipitation and tidal surge. 2016 has been a wet year in general, but due to tidal influence, that site has remained flooded most of the year. We are requesting the following additional contract days due to flooding of the private land.

Site Preparation

Heavy Construction

Underground Utilities

Construction Management

Disaster Recovery

Demolition

June – 23 days
July – 31 days
August – 6 days
September – 4 days
October – 8 days

Additionally, there were delays incurred on the pump station side of the project that we are requesting additional time for. Those days are as follows:

August – 25 days – During this month we worked a few days installing slide gates, but the pond levels got too high on 11/7/16 and had to be pumped down. The pump station pumped through the end of the month. The private land side also remained flooded.

September – 26 days - The pump station was kept in operation to lower the pond levels until 9/11/16. After a day of pumping water out of the wetwell, we were able to get started on the slide gate in the wetwell but unable to complete it

because the ponds had to be pumped down again starting on 9/17/16. The pump station remained pumping through the end of the month. The private land side also remained flooded.

October – 23 days - During October the pump station caught up on the levels of the pond. We were able to install the slide gate in the wetwell starting 10/3/16 thru 10/7/16. On 10/8/16, flushing of the discharge pipe using the pump station pumps began. We met on site on 10/18/16 and observed that air was still coming out of the pipe and coordinated on performing another test on 10/19/16. This test failed and it was decided to try to gravity flow the pipe. The pond had to be given time for the levels to build back up in order to gravity flow. The pond filled up until gravity flow started on 10/26/16 and continued through the end of the month.

The private land side remained flooded until around the middle of the month. When we met on site on 10/8/16 the site had dried up enough to work so we made plans to start grading the next day. When we showed up to work, the site was back under water due to tidal influence. On 10/18/16 we used the excavator bucket to dress the road near discharge point 4. The road was still under water at this time.

November – 31 days – The gravity flow continued until November 8th when a meeting was called to discuss the flow of the system. Discharge point 1 did not have any water coming out of it under gravity flow conditions. We have not received direction yet as to how to proceed. Additionally, on 11/18/16 we were told that water quality tests showed that fecal levels in the pond were too high to be able to discharge water.

December – 2 days – Awaiting direction on how the owner would like to proceed.

We are requesting a total of 179 calendar days through December 2nd. The starting and stopping throughout this project has not allowed us to be able to build the project as originally planned. Additionally, we feel that we have substantially completed the original project scope. It is our position that the pipe cannot be successfully flushed and tested. We have made multiple attempts, without success, due to the air trapped in the line. We are committed to complete any work necessary to ensure that the system is working as intended, but request the contract to be extended for any days needed to perform those activities.

If you need any further clarifications or assistance, feel free to contact us.

Sincerely,

Cycle Construction Co., LLC

Mitchell Roth

Project Manager

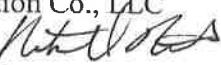



P: 504.467.1444

F: 504.467.1222

6 East Third Street

Kenner, LA 70062

December 2, 2016

Providence/GSE Engineers
991 Grand Caillou Rd.
Houma, LA 70363

Attn: Melanie Caillouet

**RE: Ashland Wetland Assimilation
Sawcut and Remove/Reinstall Top of Wetwell and Sawcut Footing off of
Wetwell**

Dear Ms. Caillouet:

Cycle Construction Co., LLC (Cycle) hereby submits a price for the work associated with removing and reinstalling the top of the wetwell and cutting the footing off of the wetwell in order to make the tie-in on the Ashland Wetland Assimilation Project. Please see the attached breakdown and relevant backup documents.

An estimate was previously submitted regarding the need to cut the top of the wetwell off for installation of the slide gate. During the work at the wetwell, it was also discovered that there was a footing/collar poured around the joint of the existing wetwell. This footing was directly in the path of the 30" pipe tie-in to the wetwell. Our previous estimate did not include the sawcutting of the footing. We have revised our price to include it.

I have attached our revised price breakdown, the emails previously sent in, and our sawcutting company's invoice with the items related to this work circled.

Additionally, we request that 7 calendar days be added to the contract as a result of this change.

We are available to meet at your earliest convenience to discuss this matter. Should you need any further information on this matter, please don't hesitate to call.

Sincerely,
Cycle Construction Co., LLC

Mitchell Roth
Project Manager

Ashland - Saw Cut Wetwell Top and Collar

Price Breakdown

- Remove Entire Top Of Wetwell & Reinstall

Bid Qty: 1.00 LS

Labor

Description	Qty	Units		Rate	%		Total
Labor Foreman	18.00	MH	\$	35.00	105.56	\$	665.03
Operator (Heavy)	18.00	MH	\$	21.26	105.56	\$	403.96
Skilled Labor	18.00	MH	\$	16.50	105.56	\$	313.51
Common Laborer	18.00	MH	\$	12.00	105.56	\$	228.01
							<hr/>
Labor Subtotal						\$	1,610.51
26% Labor Burden						\$	413.09
Fringes						\$	419.22
Per Diem						\$	1,200.00
							<hr/>
Total Labor Cost						\$	3,642.82

72.00 MH

Equipment

Description	Qty	Units		Rate	%		Total
Hyundai 145 Excavator	18.00	HR	\$	39.91	100.00	\$	718.38
Pickup (1/2 TON) (Allowance)	18.00	HR	\$	9.06	100.00	\$	163.13
							<hr/>
Total Equipment Cost						\$	881.51

36.00 HR

Material

Description	Qty	Units		Rate	%		Total
5 Star Grout	10.00	BAG	\$	25.80	100.00	\$	258.00
							<hr/>
Total Material Cost						\$	258.00

Total Material Cost \$ 258.00

Other/Outside Services

Description	Qty	Units		Rate	%		Total
Diamond Cut Footing off Wetw	1.00	LS	\$	1,232.00	100.00	\$	1,232.00
Diamond Concrete Sawing	1.00	LS	\$	1,056.00	100.00	\$	1,056.00
Diamond Per Diem	2.00	EA	\$	180.00	100.00	\$	360.00
Sawcutting Mobilization	1.00	LS	\$	342.00	100.00	\$	342.00
							<hr/>
Total Other/Outside Services Cost						\$	2,990.00

Total Other/Outside Services Cost \$ 2,990.00

Total Item Cost \$ 7,772.33

Item Overhead, Bond, & Markup \$ 1,276.93

Item Price \$ 9,049.26

Item Unit Price \$9,049.26/LS

Mitchell Roth

From: Mitchell Roth
Sent: Monday, July 25, 2016 3:51 PM
To: melaniecaillouet@providenceeng.com
Subject: Wet Well 30" Tie In
Attachments: 20160725_153054.pdf

Melanie,

Attached is a photo of the existing wet well. When we excavated, we discovered an 18" thick slab/collar poured around it. The pipe penetration that we need to make is going to intersect the bottom 8" of this slab. We will need to cut that side of the slab off in order to mount the core drill to the side of the wet well. I wanted to get your input on this.

I'll call you to follow up this email.

Thanks,

Mitchell Roth
Cycle Construction Co., LLC
6 East Third Street
Kenner, LA 70062
P: 504.467.1444
F: 504.467.1222
www.cycleconstruction.com

-----Original Message-----

From: copier@cycleconstruction.com [<mailto:copier@cycleconstruction.com>] On Behalf Of copier@
Sent: Monday, July 25, 2016 3:31 PM
To: Mitchell Roth
Subject: Scanned image from Cycle Construction

Reply to: copier@cycleconstruction.com <copier@cycleconstruction.com> **Device Name:** Cycle Construction Device
Model: MX-5141N
Location: 6 E 3rd St Kenner La

File Format: PDF (Medium)
Resolution: 200dpi x 200dpi

Attached file is scanned image in PDF format.

Use Acrobat(R)Reader(R) or Adobe(R)Reader(R) of Adobe Systems Incorporated to view the document.

Adobe(R)Reader(R) can be downloaded from the following URL:

Adobe, the Adobe logo, Acrobat, the Adobe PDF logo, and Reader are registered trademarks or trademarks of Adobe Systems Incorporated in the United States and other countries.

<http://www.adobe.com/>

Mitchell Roth

From: Mitchell Roth
Sent: Tuesday, July 26, 2016 7:41 AM
To: melaniecaillouet@providenceeng.com
Subject: Wetwell Sawcut for Install of Slide Gate
Attachments: Sawcut Wetwell Estimates.pdf

Melanie,

As previously discussed, we'll have to cut the top of the existing wetwell off in order to install the slide gate. Attached are estimates for two options.

The first option is to cut the entire top off of the wetwell. Included in this option is our crew for a day to remove the top and support the sawcutting operation, the sawcutting price, and our crew to reinstall the top after the slide gate is installed. For re-installation, we would lay a grout bed on the wall of the wetwell and set the top slab back on. I didn't include any dowels or reinforcing going back on. If you would like to add anything, please let me know.

The second option is to cut a 60" x 12" slot in the top of the wetwell. This slot would be replaced with galvanized grating. The cycle labor and equipment is the same on this estimate, but I included the sawcutting and grating materials.

On both estimates I figured that we would have a day tied up in removing the top and a day reinstalling whichever option is chosen.

Please let me know what direction you would like to take. We can get the top slab sawcut the same time as cutting the collar/slab that I emailed about yesterday if that is what you want to do.

I'm headed to the jobsite this morning so I will be available on my cell.

Thanks,

Mitchell Roth
Cycle Construction Co., LLC
6 East Third Street
Kenner, LA 70062
P: 504.467.1444
F: 504.467.1222
www.cycleconstruction.com



DIAMOND CONCRETE SAWING

10750 Hwy 603, Bay St. Louis, MS 39520

Phone: 800/968-3745 Email: AR@diamondconcretesawing.com

Invoice
Invoice Date

M805663
08/05/16

Customer Info:

AUG 22 2016

Bill To:

Job Site:

CYCLE CONSTRUCTION CO. LLC
6 EAST THIRD STREET
KENNER, LA 70062

HOUMA WET WELL
TBD
337 ASHLANDFILL RD
HOUMA, LA

Customer	Purchase Order Number	Job Date	Your Job Number	Terms	Due By								
3872		08/05/16		Net 30 Days	09/04/16								
Work Date	Qty and Description			Taxable	Ext Price								
08/05/2016	1	MOBLA - Mobilization Louisiana City: Houma		342.00 EA N	342.00								
08/05/2016	1	HTL - Hotel and Per diem		180.00 DY N	180.00								
<div><table><tr><td>PO# 401</td><td>Phase#</td></tr><tr><td>Job:# 270</td><td>Phase#</td></tr><tr><td>G/L:# 51500</td><td>Phase#</td></tr><tr><td>Appr'd:</td><td>Phase#</td></tr></table><div><p>.12.527</p><p>.13.527</p></div><p>gr</p></div>						PO# 401	Phase#	Job:# 270	Phase#	G/L:# 51500	Phase#	Appr'd:	Phase#
PO# 401	Phase#												
Job:# 270	Phase#												
G/L:# 51500	Phase#												
Appr'd:	Phase#												
PLEASE NOTE REMITTANCE ADDRESS ON RETURN STUB BELOW				Nontaxable Subtotal	5385.75								
Thank you for choosing Diamond. We appreciate your business!				Taxable Subtotal	0.00								
				Tax	0.00								
				Total Invoice	5385.75								

Check No. _____ Amount Paid _____ Date Paid _____

Please detach and return with payment

CYCLE CONSTRUCTION CO. LLC
6 EAST THIRD STREET
KENNER, LA 70062

Account No.	Invoice Date	Invoice No.	Balance Due
3872	08/05/16	M805663	\$ 5385.75
Due Date			09/04/16
Amount Enclosed			

Remit To:

DIAMOND CONCRETE SAWING

10750 Hwy 603, Bay St. Louis, MS 39520

Phone: 800/968-3745 Email: AR@diamondconcretesawing.com

Invoice

Invoice Date

M805663

08/05/16

Customer Info:

AUG 22 2016

Bill To:

CYCLE CONSTRUCTION CO. LLC
6 EAST THIRD STREET
KENNER, LA 70062

Job Site:

HOUMA WET WELL
TBD
337 ASHLANDFILL RD
HOUMA, LA

Customer	Purchase Order Number	Job Date	Your Job Number	Terms	Due By
3872		08/05/16		Net 30 Days	09/04/16
Work Date	Qty and Description			Taxable	Ext Price
08/01/2016	28 WAL - Wall Sawing Depth: 8" or Less cut 28' cut the top off a box			32.00 LF N	896.00
08/01/2016	1 MOBLA - Mobilization Louisiana City: Houma			342.00 EA N	342.00
08/01/2016	1 HTL - Hotel and Per diem			180.00 DY N	180.00
			SUBTOTAL \$1418.00		
08/02/2016	1 2 Men WAL - Wall Sawing Depth: 12" cut 14 feet			850.00 LS N	850.00
08/02/2016	1 HTL - Hotel and Per diem 2 men			180.00 DY N	180.00

Check No. _____ Amount Paid _____ Date Paid _____

Please detach and return with payment

CYCLE CONSTRUCTION CO. LLC
6 EAST THIRD STREET
KENNER, LA 70062

Account No.	Invoice Date	Invoice No.	Balance Due
3872	08/05/16	M805663	
		Due Date	09/04/16
		Amount Enclosed	

Remit To:

Diamond Concrete Sawing
Dept 4020
PO Box 30516
Lansing, MI 48909-8016

(Continued)

Customer Original

Page 1

DIAMOND CONCRETE SAWING

10750 Hwy 603, Bay St. Louis, MS 39520

Phone: 800/968-3745 Email: AR@diamondconcretesawing.com

Invoice
Invoice Date

M805663
08/05/16

Customer Info:

Bill To:

CYCLE CONSTRUCTION CO. LLC
6 EAST THIRD STREET
KENNER, LA 70062

Job Site:

HOUMA WET WELL
TBD
337 ASHLANDFILL RD
HOUMA, LA

Customer	Purchase Order Number	Job Date	Your Job Number	Terms	Due By
3872		08/05/16		Net 30 Days	09/04/16
Work Date	Qty and Description			Taxable	Ext Price
08/02/2016	4.5 CDW - Core Drilling Wall Diameter: 1/2" Depth: 8.00 help Lance and Brad with setup of walls. getting all equipment in 20 ft trench			187.50 HR N	843.75
08/03/2016	14 WAL - Wall Sawing Depth: 22" Cut Footing Off Side Of Box			88.00 LF N	1232.00
08/03/2016	5 WAL - Wall Sawing Depth: 8" or Less			32.00 LF N	160.00
08/03/2016	1 HTL - Hotel and Per diem			180.00 DY N	180.00
	2 men				
SUBTOTAL \$1,572.00					

Check No. _____ Amount Paid _____ Date Paid _____

Please detach and return with payment

CYCLE CONSTRUCTION CO. LLC
6 EAST THIRD STREET
KENNER, LA 70062

Account No.	Invoice Date	Invoice No.	Balance Due
3872	08/05/16	M805663	
		Due Date	09/04/16
		Amount Enclosed	

Remit To:

Total \$ 2,990.00

(Continued)

Customer Original

Page 2



EXECUTIVE SUMMARY

(REQUIRED FOR ALL SUBMISSIONS)

PROJECT TITLE
Parish Project No. 10-SEW-96 CWSRF Contract No. 221492-01 Ashland Wetland Assimilation Discharge System

PROJECT SUMMARY (200 WORDS OR LESS)
This project will reroute the sewer discharge from the Houma Navigation Canal via header system to the wetlands.

PROJECT PURPOSE & BENEFITS (150 WORDS OR LESS)
Change Order No. 3 will increase the contract price by \$17,117.15, and increase the calendar days by 281 days, for additional fill material, discharge header #4 support structure, remove concrete footing on existing wetwell and pressure testing of sewer discharge will not be required.

TOTAL EXPENDITURE
\$17,117.15
AMOUNT SHOWN ABOVE IS: (CIRCLE ONE)
ACTUAL ESTIMATED
IS PROJECT ALREADY BUDGETED: (CIRCLE ONE)
N/A NO YES IF YES AMOUNT BUDGETED: \$2,000,000

COUNCIL DISTRICT(S) IMPACTED (CIRCLE ONE)
PARISHWIDE 1 2 3 4 5 6 7 8 9

Signature

Raymond E. Dutil

Date

1/17/17



Monday, January 23, 2017

Item Title:

Change Order No. 5 (Balancing) for Ward 7 Phase I Bayou Neuf to East Houma Surge Levee

Item Summary:

RESOLUTION: Authorizing the execution of Change Order No. 5 (Balancing) for the Construciton Agreement for Parish Project No. 10-CDBG-R-LEV-63; Ward 7 Levee Improvements & Extension Phase I, Bayou Neuf to East Houma Surge Levee Project, Terrebonne Parish, Louisiana.

ATTACHMENTS:

Description	Upload Date	Type
Executive Summary	1/17/2017	Executive Summary
Resolution	1/17/2017	Resolution
Backup Material	1/17/2017	Backup Material



EXECUTIVE SUMMARY

(REQUIRED FOR ALL SUBMISSIONS)

PROJECT TITLE	
Project No. 10-CDBG-R-LEV-63	Ward 7 Levee Improvements and Extension Phase I Bayou Neuf to East Houma Surge Levee

PROJECT SUMMARY (200 WORDS OR LESS)
To construct and elevate the existing levee to elevation 10 from Bayou Neuf to the East Houma Surge Levee.

PROJECT PURPOSE & BENEFITS (150 WORDS OR LESS)
This Change Order No. 5 (Balancing) is necessary to balance contract quantities with installed quantities on the project. This Change Order No. 5 (Balancing) has no increase in contract time.

TOTAL EXPENDITURE		
Decrease of \$205,692.82		
AMOUNT SHOWN ABOVE IS: (CIRCLE ONE)		
<u>ACTUAL</u>	ESTIMATED	
IS PROJECTALREADY BUDGETED: (CIRCLE ONE)		
N/A	NO	<div>YES<div>IF YES AMOUNT BUDGETED:\$3,931,750.48</div></div>

COUNCIL DISTRICT(S) IMPACTED (CIRCLE ONE)										
PARISHWIDE	1	2	3	4	5	6	7	<u>8</u>	9	

Jeanne Bray

01/18/2017

Signature

Date

OFFERED BY:
SECONDED BY:

RESOLUTION

A resolution authorizing the execution of Change Order No. 5 (Balancing) for the Construction Agreement for Parish Project No. 10-CDBG-R-LEV-63; Ward 7 Levee Improvements & Extension Phase I, Bayou Neuf to East Houma Surge Levee Project, Terrebonne Parish, Louisiana.

WHEREAS, the Terrebonne Parish Consolidated Government entered into a contract dated May 7, 2014, with Apeck Construction, LLC, for the Ward 7 Levee Improvements & Extension Phase I, Bayou Neuf to East Houma Surge Levee, Parish Project No. 10-CDBG-R-LEV-63, Terrebonne Parish, Louisiana, and

WHEREAS, this change order is required to balance contract quantities with installed quantities on the project, and

WHEREAS, this change order will decrease the contract by \$205,692.82 with no change in contract time, and

WHEREAS, this change order has been approved by the Louisiana Office of Community Development (OCD), and

WHEREAS, this Change Order No. 5 (Balancing) has been recommended by the ENGINEER for this project, CB&I Coastal, Inc., and

NOW, THEREFORE BE IT RESOLVED that the Terrebonne Parish Council, on behalf of the Terrebonne Parish Consolidated Government, does hereby approve and authorize the execution by Terrebonne Parish President Gordon E. Dove of Change Order No. 5 (Balancing) to the construction agreement with Apeck Construction, LLC, for a decrease of Two Hundred Five Thousand, Six Hundred Ninety-Two Dollars and Eighty-Two Cents (\$205,692.82) with no increase in contract time, and

BE IT FURTHER RESOLVED that a certified copy of the resolution be forwarded to the Engineer, CB&I Coastal, Inc.

THERE WAS RECORDED:

YEAS:

NAYS:

NOT VOTING:

ABSENT

And the Chairman declared the resolution adopted on this _____ day of _____, 2017.

* * * * *

I, VENITA CHAUVIN, Clerk of the Terrebonne Parish Council, Houma, Louisiana, do hereby certify that the foregoing is a true and correct copy of the RESOLUTION adopted by the Terrebonne Parish Council on _____, 2017, at which meeting a quorum was present.

GIVEN UNDER MY OFFICIAL SIGNATURE AND SEAL OF OFFICE THIS DAY OF _____, 2017.

VENITA CHAUVIN, CLERK
TERREBONNE PARISH COUNCIL



**PAN AMERICAN
ENGINEERS, LLC**

Consulting Professional
Engineers and Land Surveyors

January 16, 2017

Terrebonne Parish
P. O. Box 6097
Houma, Louisiana 70361

Attention: The Honorable Gordon E. Dove, President

Re: Terrebonne Parish
Non-Fed Levee-Ward 7
Phase I
Change Order No. 5
Apeck Construction, LLC - Contractor
Project Number 55PARA3306
PAE Job No. 8470

Dear President Dove:

On behalf of OCD/DRU, we have reviewed the attached proposed Change Order No. 5 provided by Terrebonne Parish for the referenced project, and take no exception to the \$205,692.82 reduction in contract price, provided the reduction is mutually agreed upon by all contracting parties.

Change Order No. 5 provides a \$205,692.82 reduction in order to adjust to the quantities actually installed.

Once the Change Order is fully executed, please have CB&I Coastal, Inc. furnish us with a copy for our files.

Please note that this review is only to verify general conformance with project scope and cost in the grant application/amended applications and to determine reasonableness. Our review does not include a review against the Environmental Review Record (ERR), which shall be performed by the applicant or their representative to determine if changes or additional environmental clearances are needed. In addition, the review is non-technical in nature and does not include review of design, constructability, or compliance with codes, regulations, and public bid law.

(Continued)

January 16, 2017

Re: Terrebonne Parish
Non-Fed Levee-Ward 7
Phase I
Change Order No. 5
Apeck Construction, LLC - Contractor
Project Number 55PARA3306
PAE Job No. 8470



**PAN AMERICAN
ENGINEERS, LLC**

Consulting Professional
Engineers and Land Surveyors

Page 2

If you have any questions or require additional information, please do not hesitate to contact our office for assistance.

Yours very truly,

PAN AMERICAN ENGINEERS, LLC

Thomas C. David, Jr.

TCDJr/jmg
Enclosure

Ms. Lisa Samuels
OCD-DRU

Ms. Niayonda Picou-Bowen
Terrebonne Parish

Attachment: Change Order No. 5

**CDBG DISASTER RECOVERY
CHANGE ORDER REVIEW CHECKLIST**

Applicant: Terrebonne Parish

Project No.: 55PARA3306

Project Name: Non-fed Levee – Ward 7

Document Reviewed: Change Order No. 5

Change Order Prepared By: CB&I Coastal, Inc.

Contractor: Apeck Construction, LLC

CHANGE ORDER PROPOSAL

Approved Grant Amount = \$ 14,320,768.00
Bid Amount = \$ 4,013,056.80
Change Order Proposal = \$ -205,692.82
Previous Change Orders = \$ 124,386.50
Revised Construction Cost = \$ 3,931,750.48
Revised CDBG Funded Amount = \$

1. Is the Change Order recommended by the Engineer or Architect of Record? Yes ☒ No ☐
 2. Has the Change Order been approved by the Applicant?
Pending approval of this review. Yes ☐ No ☒
 3. Does the intent of the Change Order match the following from the Grant Application:
 - a. Project Description Yes ☒ No ☐
 - b. Project Maps with Existing Conditions and proposed improvements. Yes ☒ No ☐
 4. Is the revised Project Scope the same as the original Application? Yes ☒ No ☐ N/A ☐
 5. Is the Change Order amount within the amount funded by the Application? Yes ☒ No ☐ N/A ☐
 6. Is the Change Order amount reasonable? Yes ☒ No ☐ N/A ☐
-

**CDBG DISASTER RECOVERY
CHANGE ORDER REVIEW CHECKLIST**

7. Is the Change Order documented in accordance with R.S. 38:2212.M.(5) related to labor, materials, equipment, overhead and profit?

Yes ☒ No ☐ N/A ☐

REASON FOR CHANGE ORDER

Adjust final quantities to the quantities actually installed.

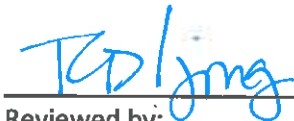

Reviewed by:
Thomas C. David, Jr.

Date: 1/16/2017

This review is only to verify general conformance with project scope and cost in the Grant Application and to determine if the Change Order costs are reasonable. The review is non-technical in nature and does not include review of design, constructability, or compliance with codes, regulations and public bid law.

CHANGE ORDER NO. 5 AND FINAL

PROJECT:

Ward 7 Levee Improvements & Extension
Phase I: Stations 550+05 to 791+31
Bayou Neuf to East Houma Surge Levee

OWNER:

Terrebonne Parish Consolidated Government
P.O. Box 6097
Houma, Louisiana 70361

DATE OF ISSUANCE:

January 10, 2017

OWNER'S PROJECT NO.

10-CDBG-R-LEV-63

CONTRACTOR:

Apeck Construction, LLC
P. O. Box 640
Anacoco, LA 71403
337-239-6353

ENGINEER:

CB&I Coastal, Inc.
197 Elysian Drive
Houma, Louisiana 70364

CONTRACT FOR:

Ward 7 Levee Improvements & Extension
Phase I: Stations 550+05 to 791+31
Bayou Neuf to East Houma Surge Levee

ENGINEER'S PROJECT NO.

141235

You are directed to make the following changes in the Contract Documents.

Description:

This change order is the final balancing change order to complete the project. Bid Items No. 3, 4, 5, 14, 16, 17, 20, 22, 23, 24, 25, 26, & 40 are completed and adjusted to the quantities actually installed.

Purpose of Change Order:

The purpose of this change order is to balance the FINAL work quantities.

CHANGE IN CONTRACT PRICE:

Original Contract Price

\$ 4,013,056.80

Previous Change Orders No. 0 to No. 4

\$ 124,386.50

Contract Price Prior to this Change Order

\$ 4,137,443.30

Net Increase of this Change Order

\$ (205,692.82)

Contract Price with all approved Change Orders

\$ 3,931,750.48

CHANGE IN CONTRACT TIME:

Original Contract Time

270 Calendar Days

days

March 4, 2015

date

Net Change from previous Change Orders

241 Days

days

Contract Time Prior to this Change Order

511 Calendar Days

days

October 31, 2015

date

Net Increase of this Change Order

0 Days

days

Contract Time with all approved Change Orders

511 Calendar Days

days

October 31, 2015

date

RECOMMENDED:

By: 

Date: 1-12-17

CBI

APPROVED:

By: _____

Date: _____

TPCG

APPROVED:

By: 

Date: 1-11-17

CONTRACTOR

CHANGE ORDER NO. 5 AND FINAL

Ward 7 Levee Improvements & Extension Phase I: Stations 550+05 to 791+31 Bayou Neuf to East Houma Surge Levee TPCG Project No. 10-CDBG-R-LEV-10 CBI Project No. 141235

Change Order No. 5 Summary

Change Order No. 5 will decrease the total Construction Cost from \$4,137,443.30 to \$3,931,750.48, which is a total decrease of **(\$205,692.82)**.

Item No.	Item	Unit	Unit Cost	Original Qty	Original Bid \$ Amount	Net Change in Qty	Net Change in \$ Amount	Bid Item Total Quantity	Bid Item Total \$ Amount
3	Temporary Silt Fencing	LF	\$2.40	28,000	\$67,200.00	(1,000)	(\$2,400.00)	27,000.00	\$64,800.00
4	Earthen Embankment (Hauled-in), including placing, grading, and handling	CY	\$8.00	130,000	\$1,040,000.00	5,532.67	\$44,261.36	135,532.67	\$1,084,261.36
5	Dredging, including placing, grading, and handling	CY	\$4.15	80,390	\$333,618.50	(3,323)	(\$13,789.62)	77,067.20	\$319,828.88
14	Cross Drain Pipe (48" corrugated HDPE, Type S) for Sta. 767+77, Sta. 786+57, under Access Road at Sta. 790+00, and under EHSL, including material and installation as shown on plans	LF	\$474.00	715	\$338,910.00	(38)	(\$18,012.00)	677.00	\$320,898.00
16	Cross Drain Pipe (24" BCCSP) at Sta. 776+02 and Sta. 779+75, including material and installation as shown on plans	LF	\$362.00	236	\$85,432.00	(1)	(\$362.00)	235.00	\$85,070.00
17	River Sand (for culvert bedding), including material and labor	CY	\$33.00	700	\$23,100.00	(220)	(\$7,260.00)	480.00	\$15,840.00
20	Seeding (Type A, Hulled Bermuda)	Acre	\$473.00	75	\$35,475.00	(75)	(\$35,475.00)	0.00	\$0.00
22	Geotextile Fabric for under broken concrete, rip rap, limestone, and river sand, including, labor and materials for installation	SY	\$2.00	10,300	\$20,600.00	(5,907.68)	(\$11,815.36)	4,392.32	\$8,784.64
23	Rip Rap (55lb Class)	Ton	\$62.45	6,604	\$412,439.06	(2,384)	(\$148,854.47)	4,220.73	\$263,584.59
24	No. 610 Limestone (for temporary access roadway and main access road maintenance), including material and labor	Ton	\$47.00	1,900	\$89,300.00	(186.02)	(\$8,742.94)	1,713.98	\$80,557.06

CHANGE ORDER NO. 5 AND FINAL

25	Sheet Piling System 800 Series (manufactured by Truline or approved equal) including material and installation as shown on the plans	SF	\$37.60	1,425	\$53,580.00	(19)	(\$714.40)	1,406.00	\$52,865.60
26	Calcium Chloride for Dust Control	Gallon	\$4.00	1,000	\$4,000.00	(1,000)	(\$4,000.00)	0.00	\$0.00
40	No. 57 Limestone (for access road maintenance), including material and labor	Ton	\$51.64	75	\$3,872.66	28.5	\$1,471.61	103.50	\$5,344.27
Net Change in Contract Value							(\$205,682.82)		

Recommended:

By: _____
CBI

By: _____
TPCG

By: _____
CONTRACTOR

Date: _____

Date: _____

Date: _____



Monday, January 23, 2017

Item Title:

Appointment of All South Consulting Engineers to Valhi Extension Line and Grade Study

Item Summary:

RESOLUTION Ratifying the appointment of the firm of All South Consulting Engineers, LLC to provide professional services for the Valhi Extension Line and Grade Study, Parish Project No. 17-ROAD-02; and authorizing the execution of an agreement for these services.

ATTACHMENTS:

Description	Upload Date	Type
Executive Summary	1/17/2017	Executive Summary
Resolution	1/17/2017	Resolution



EXECUTIVE SUMMARY

(REQUIRED FOR ALL SUBMISSIONS)

PROJECT TITLE	
17-ROAD-02	Valhi Extension Line and Grade Study

PROJECT SUMMARY (200 WORDS OR LESS)
To appoint All South Consulting Engineers, LLC to provide engineering services for the Valhi Extension Line and Grade Study project.

PROJECT PURPOSE & BENEFITS (150 WORDS OR LESS)
The purpose of this appointment is to provide engineering services for the evaluation of the feasibility of connecting Valhi Boulevard to Ellendale Boulevard.

TOTAL EXPENDITURE	
N/A	
AMOUNT SHOWN ABOVE IS: (CIRCLE ONE)	
ACTUAL	ESTIMATED
IS PROJECTALREADY BUDGETED: (CIRCLE ONE)	
<u>N/A</u>	NO
YES	IF YES AMOUNT BUDGETED:
N/A	

COUNCIL DISTRICT(S) IMPACTED (CIRCLE ONE)									
PARISHWIDE	1	2	3	4	5	<u>6</u>	7	8	9

Jeanne P. Bray

01/18/2017

Signature

Date

OFFERED BY:
SECONDED BY:

RESOLUTION

A resolution ratifying the appointment of the firm of All South Consulting Engineers, LLC to provide professional services for the **Valhi Extension Line and Grade Study, Parish Project No. 17-ROAD-02**; and authorizing the execution of an agreement for these services.

WHEREAS, Terrebonne Parish Consolidated Government is desirous of evaluating the feasibility of connecting Valhi Boulevard to Ellendale Boulevard, and

WHEREAS, the Terrebonne Parish Consolidated Government is desirous of appointing a firm to provide professional services for the project entitled **Valhi Extension Line and Grade Study, Parish Project No. 17-ROAD-02**, and

WHEREAS, the firm of All South Consulting Engineers, LLC has been selected by Terrebonne Parish President Gordon E. Dove to provide the professional services relative to said project, and

NOW, THEREFORE BE IT RESOLVED that the Terrebonne Parish Council does hereby ratify the appointment of the firm of All South Consulting Engineers, LLC by Terrebonne Parish President Gordon E. Dove for professional services for the **Valhi Extension Line and Grade Study, Parish Project No. 17-ROAD-02**, and

BE IT FURTHER RESOLVED that the Terrebonne Parish Council, on behalf of the Terrebonne Parish Consolidated Government, does hereby authorize the execution of an agreement with the firm of All South Consulting Engineers, LLC by Terrebonne Parish President Gordon E. Dove.

THERE WAS RECORDED:

YEAS:
NAYS:
NOT VOTING:
ABSENT

And the Chairman declared the resolution adopted on this _____ day of _____, 2017.

* * * * *

I, VENITA CHAUVIN, Clerk of the Terrebonne Parish Council, Houma, Louisiana, do hereby certify that the foregoing is a true and correct copy of the RESOLUTION adopted by the Terrebonne Parish Council on _____, 2017, at which meeting a quorum was present.

GIVEN UNDER MY OFFICIAL SIGNATURE AND SEAL OF OFFICE THIS _____ DAY OF _____, 2017.

VENITA CHAUVIN, CLERK
TERREBONNE PARISH COUNCIL



Monday, January 23, 2017

Item Title:

Appointment of David A Waitz for Wauban Subdivision Drainage Project

Item Summary:

RESOLUTION: Ratifying the appointment of the firm of David A. Waitz Engineering and Surveying, Inc. to provide professional services for the Wauban Subdivision Drainage Project, Parish Project No. 17-DRA-03; and authorizing the execution of an agreement for these services.

ATTACHMENTS:

Description	Upload Date	Type
Executive Summary	1/17/2017	Executive Summary
Resolution	1/17/2017	Resolution



EXECUTIVE SUMMARY

(REQUIRED FOR ALL SUBMISSIONS)

PROJECT TITLE	
17-DRA-03	Wauban Subdivision Drainage

PROJECT SUMMARY (200 WORDS OR LESS)
To appoint David A. Waitz Engineering and Surveying, Inc. to provide engineering services for the Wauban Subdivision Drainage project.

PROJECT PURPOSE & BENEFITS (150 WORDS OR LESS)
The purpose of this appointment is to provide engineering services for the construction of the Wauban Subdivision Drainage Project.

TOTAL EXPENDITURE	
N/A	
AMOUNT SHOWN ABOVE IS: (CIRCLE ONE)	
ACTUAL	ESTIMATED
IS PROJECTALREADY BUDGETED: (CIRCLE ONE)	
<u>N/A</u>	NO
YES	IF YES AMOUNT BUDGETED:
N/A	

COUNCIL DISTRICT(S) IMPACTED (CIRCLE ONE)									
PARISHWIDE	1	2	3	<u>4</u>	5	6	7	8	9

Jeanne P. Bray

01/18/2017

Signature

Date

OFFERED BY:
SECONDED BY:

RESOLUTION

A resolution ratifying the appointment of the firm of David A. Waitz Engineering and Surveying, Inc. to provide professional services for the **Wauban Subdivision Drainage Project, Parish Project No. 17-DRA-03**; and authorizing the execution of an agreement for these services.

WHEREAS, Terrebonne Parish Consolidated Government is desirous of improving drainage in the Wauban Street area, and

WHEREAS, the Terrebonne Parish Consolidated Government is desirous of appointing a firm to provide professional services for the project entitled **Wauban Subdivision Drainage Project, Parish Project No. 17-DRA-03**, and

WHEREAS, the firm of David A. Waitz Engineering and Surveying, Inc. has been selected by Terrebonne Parish President Gordon E. Dove to provide the professional services relative to said project, and

NOW, THEREFORE BE IT RESOLVED that the Terrebonne Parish Council does hereby ratify the appointment of the firm of David A. Waitz Engineering and Surveying, Inc. by Terrebonne Parish President Gordon E. Dove for professional services for the **Wauban Subdivision Drainage Project, Parish Project No. 17-DRA-03**, and

BE IT FURTHER RESOLVED that the Terrebonne Parish Council, on behalf of the Terrebonne Parish Consolidated Government, does hereby authorize the execution of an agreement with the firm of David A. Waitz Engineering and Surveying, Inc. by Terrebonne Parish President Gordon E. Dove.

THERE WAS RECORDED:

YEAS:
NAYS:
NOT VOTING:
ABSENT

And the Chairman declared the resolution adopted on this _____ day of _____, 2017.

* * * * *

I, VENITA CHAUVIN, Clerk of the Terrebonne Parish Council, Houma, Louisiana, do hereby certify that the foregoing is a true and correct copy of the RESOLUTION adopted by the Terrebonne Parish Council on _____, 2017, at which meeting a quorum was present.

GIVEN UNDER MY OFFICIAL SIGNATURE AND SEAL OF OFFICE THIS _____ DAY OF _____, 2017.

VENITA CHAUVIN, CLERK
TERREBONNE PARISH COUNCIL

Category Number:
Item Number: 7.



Monday, January 23, 2017

Item Title:

Award and authorization to sign Construction Contract for South Wastewater Treatment Plant Improvements, Parish Project No. 15-SEW-18

Item Summary:

RESOLUTION: Awarding and authorizing the signing of Construction Contract with Synagro South, LLC, in the amount of \$571,500.00, for South Plant Improvements, Parish Project No. 15-SEW-18.

ATTACHMENTS:

Description	Upload Date	Type
Resolution	1/18/2017	Resolution
Backup - Bid Tab	1/18/2017	Backup Material
Executive Summary	1/18/2017	Executive Summary

OFFERED BY:
SECONDED BY:

RESOLUTION NO. _____

A resolution awarding and authorizing the signing of the Construction Contract for the South Wastewater Treatment Plant Improvements, Parish Project No. 15-SEW-18, Terrebonne Parish, Louisiana, and authorizing the issuance of the Notice to Proceed.

WHEREAS, Terrebonne Parish Consolidated Government did receive construction bids on November 22, 2016, for the South Wastewater Treatment Plant Improvements, under Parish Project No. 15-SEW-18, Terrebonne Parish, Louisiana, and

WHEREAS, the lowest responsive bid was that submitted by Synagro South, LLC, in the overall amount of \$571,500.00 has been reviewed and recommended by the Engineer, and

NOW THEREFORE BE IT RESOLVED, that the Terrebonne Parish Consolidated Government award the construction contract to Synagro South, LLC, in the overall amount of \$571,500.00, and

BE IT FURTHER RESOLVED, that the President of Terrebonne Parish Consolidated Government, be and he is hereby authorized and empowered to sign a construction contract for and on behalf of the Terrebonne Parish Consolidated Government with Synagro South, LLC, upon receipt of the performance bond in the amount of the contract price, and

BE IT FURTHER RESOLVED that upon receipt of required certificates of insurance evidencing coverage as provided in the project specifications and upon execution and recordation of all contract documents, that the Engineer is hereby authorized to issue the Notice to Proceed to the Contractor to commence construction of the project.

THERE WAS RECORDED:
YEAS:
NAYS:
NOT VOTING:
ABSENT:

The Chairman declared this resolution adopted this _____ day of _____, 2017.

* * * * *

I, VENITA H. CHAUVIN, Council Clerk of Terrebonne Parish Council, do hereby certify that the foregoing is a true and correct copy of a resolution adopted by the Public Services Committee on _____, 2017 and subsequently ratified by the Assembled Council in Regular Session on _____, 2017, at which meeting a quorum was present.

GIVEN UNDER MY OFFICIAL SIGNATURE AND SEAL OF OFFICE THIS _____ DAY OF _____, 2017.

VENITA H. CHAUVIN, COUNCIL CLERK
TERREBONNE PARISH COUNCIL



December 9, 2016

LTC Gregory E. Bush, USA (Ret.)
Pollution Control Administrator
Terrebonne Parish Consolidated Government
P.O. Box 2768
Houma, LA 70361

Subject: 15-SEW-18 – South WWTP Improvements Project
Recommendation of Award

Dear LTC Bush:

Bids for the South WWTP Improvements, Parish Project No. 15-SEW-18, were received on November 22, 2016 at 2:00-pm, as summarized in the attached bid tabulation. The lowest responsive bid of \$571,500.00 was submitted by Synagro South, LLC.

Though the bids exceed the budget of \$400,000, we recommend the Parish accept the low bid if funds are available.

Sincerely,

Robert Heath, PE
GreenPoint Engineering

Attachment

TERREBONNE PARISH
CONSOLIDATED GOVERNMENT

DEC 13 2016

POLLUTION CONTROL

Attachment A

Certified Bid Tabulation

Project: South WWTP Improvements Project
Project No.: 15-SEW-18 **Bid Date:** 11/22/2016 **Time:** 2:00 p.m.

CONTRACTOR NAME	State License No.	Total Base Bid Price	Signed Louisiana Uniform Public Work Bid Form	Acknowledgement Of Addenda	Bid Form Signatory Authorization Documentation	Bid Security (5%)
Synagro South, LLC	37913	\$571,500.00	YES	YES	NO*	YES
Denali Water Solutions LLC	59002	\$653,225.00	YES	YES	NO*	YES
SEMS, Inc.	27770	\$1,005,800.00	YES	YES	NO*	YES

**Documentation of signatory's authority was not provided, though the signatory is a titled officer.*

Certified Correct:

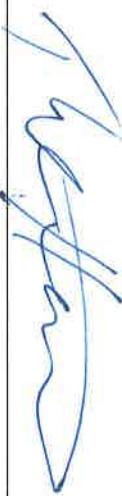
Robert L. Heath, PE
GreenPoint Engineering
November 30, 2016
Date





EXECUTIVE SUMMARY

(REQUIRED FOR ALL SUBMISSIONS)

PROJECT III

Parish Project No. 15-SEW-18 South Treatment Plant Improvements (Dredging of the Aeration Basin)

PROJECT SUMMARY (200 WORDS OR LESS)

A Resolution awarding the construction bid to Synagro South, LLC, in the amount of \$571,500.00, as per the recommendation of the project engineer, GreenPoint Engineering, LLC.

PROJECT PURPOSE & BENEFITS (150 WORDS OR LESS)

Sludge removal by Dredging the Aeration Basin at the South Treatment Plant.

TOTAL EXPENDITURE

\$571,500.00

AMOUNT SHOWN ABOVE IS: (CIRCLE ONE)

ACTUAL

ESTIMATED

IS PROJECT ALREADY BUDGETED: (CIRCLE ONE)

[illegible]

ESTIMATED AMOUNT BUDGETED: \$700,000

COUNCIL DISTRICT(S) IMPACTED (CIRCLE ONE)

[illegible]

Signature *E. Paul*

Signature

Date _____

1/17/17



Monday, January 23, 2017

Item Title:

Awarding the Construction Contract for Coteau Dredging

Item Summary:

RESOLUTION: Awarding and authorizing the signing of the construction contract for Parish Project No.16-SEW-44, East Coteau/Bayou Blue Sewer Holding Basin Dredging, Terrebonne Parish Consolidated Government, Terrebonne Parish, Louisiana, and authorizing the issuance of the Notice to Proceed.

ATTACHMENTS:

Description	Upload Date	Type
Executive Summary	1/18/2017	Executive Summary
Resolution	1/18/2017	Resolution
Backup Material	1/18/2017	Backup Material



EXECUTIVE SUMMARY

(REQUIRED FOR ALL SUBMISSIONS)

PROJECT TITLE

Parish Project No. 16-SEW-44 East Coteau/Bayou Blue Sewer Holding Basin Dredging

PROJECT SUMMARY (200 WORDS OR LESS)

The purpose of this contract is to provide construction services for the dredging of the East Coteau/Bayou Blue Sewer Holding Basin

PROJECT PURPOSE & BENEFITS (150 WORDS OR LESS)

This resolution allows for the awarding of the bid to Synagro South, LLC.

TOTAL EXPENDITURE

\$273,000.00

AMOUNT SHOWN ABOVE IS: (CIRCLE ONE)

ACTUAL

ESTIMATED

IS PROJECTALREADY BUDGETED: (CIRCLE ONE)

N/A	NO	YES	IF YES AMOUNT BUDGETED:	
				\$300,000.00

COUNCIL DISTRICT(S) IMPACTED (CIRCLE ONE)

PARISHWIDE	1	2	3	4	5	6	7	8	9

<u>Angela E. Reed</u> Signature	<u>11/8/17</u> Date
------------------------------------	------------------------

OFFERED BY:
SECONDED BY:

RESOLUTION

A resolution awarding and authorizing the signing of the construction contract for Parish Project No.16-SEW-44, East Coteau/Bayou Blue Sewer Holding Basin Dredging, Terrebonne Parish Consolidated Government, Terrebonne Parish, Louisiana, and authorizing the issuance of the Notice to Proceed.

WHEREAS, the Terrebonne Parish Consolidated Government did receive construction bids on Parish Project No. 16-SEW-44, East Coteau/Bayou Blue Sewer Holding Basin Dredging, Terrebonne Parish, Louisiana, and,

WHEREAS, the lowest responsive bid was that submitted by Synagro South, LLC., in the overall amount of \$273,000.00, and

NOW, THEREFORE, BE IT RESOLVED that the Terrebonne Parish Consolidated Government award the construction contract to Synagro South, LLC, in the overall amount of \$273,000.00, and

BE IT FURTHER RESOLVED, that the President of Terrebonne Parish Consolidated Government, be and he is hereby authorized and empowered to sign a construction contract for and on behalf of the Terrebonne Parish Consolidated Government with Synagro South, LLC., upon receipt of the performance bond in the amount of the contract price, and

BE IT FURTHER RESOLVED, that upon receipt of required certificates of insurance evidencing coverage as provided in the project specifications and upon execution and recordation of all contract documents, that the Engineer is hereby authorized to issue the Notice to Proceed to the Contractor to commence construction of the project.

THERE WAS RECORDED:

YEAS:
NAYS:
NOT VOTING:
ABSENT

And the Chairman declared the resolution adopted on this _____ day of _____, 2017.

* * * * *

I, VENITA H. CHAUVIN, Clerk of the Terrebonne Parish Council, Houma, Louisiana, do hereby certify that the foregoing is a true and correct copy of the RESOLUTION adopted by the Terrebonne Parish Council on _____, 2017, at which meeting a quorum was present.

GIVEN UNDER MY OFFICIAL SIGNATURE AND SEAL OF OFFICE THIS _____ DAY OF _____, 2017.

VENITA H. CHAUVIN, CLERK
TERREBONNE PARISH COUNCIL



Coastal Design & Infrastructure

2503 Petroleum Drive | Suite 110
Houma, LA 70363
P: (985) 219-1000 | F: (985) 475-7014
www.gisyseng.com

January 11, 2017

Terrebonne Parish Consolidated Government
Pollution Control
2000 St. Louis Canal Rd.
Houma, Louisiana 70360

Attention: Mr. Gregory E. Bush, Lt. Col, USA, Retired,
Pollution Control Administrator

Subject: Bid Evaluation & Award Recommendation

Reference: E. Coteau Bayou Blue
Sewer Holding Basin Dredging Project
Parish Project No. 16-SEW-14

Mr. Bush:

GIS Engineering, LLC. has reviewed the bids received on December 20, 2016 for the above referenced project. This letter addresses our findings and recommendations. The bid results are listed below:

	Contractor Name	Base Bid
1	Merrel Bros, Inc.	\$256,895.00
2	Synagro South, LLC	\$273,000.00
3	Denali Water Solutions, LLC	\$323,170.00
4	Magnolia Dredging & Dock, LLC	\$394,570.10
5	Zealous Energy Services.	\$420,460.00

Enclosed herewith is the "Bid Evaluation Summary" containing the evaluation results of the bids received and the "Bid Tabulation Summary" outlining each of the dollar amounts of the received bid.

EVALUATION

Merrel Bros, Inc. was the apparent low bidder at the time of the bid in the amount of \$256,895.00. After evaluation of the bid the following was found:

- As per paragraph 1.2.3 of Technical Specification 01010 – Mobilization and Demobilization, the cost of Mobilization and Demobilization "shall be limited to 10% of the total base bid amount including the bid item for "Mobilization and Demobilization". Based on the submitted bid, the amount for Bid Item No. 1 "Mobilization and Demobilization" exceeds 10% of the total bid.

According to bid law La R.S 38:2212(B)(1) the Owner is mandated to reject a bid that does not comply with the bidding documents, therefore, GIS Engineering, LLC deems Merrel Bros, Inc. as a "non-responsive" bidder.

Synagro South, LLC was the 2nd apparent low bidder at \$273,000.00. After evaluation of the bid, all items submitted comply with the bidding documents.

RECOMMENDATION:

Based on our evaluation and contingent upon concurrence by the Terrebonne Parish Consolidated Government and its legal counsel, GIS Engineering, LLC recommends award of the Base Bid for the East Coteau/Bayou Blue, Sewer Holding Basin Dredging Project Contract to the responsive low bidder, Synagro LLC, in the amount of **TWO HUNDRED SEVENTY-THREE THOUSAND DOLLARS AND ZERO CENTS (\$273,000.00).**

If you have any questions or require any additional information, please contact me at (985) 219-1000.

Sincerely,

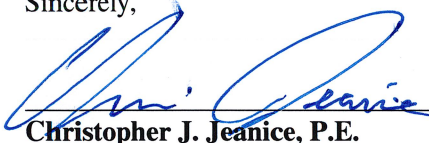

Christopher J. Jeanice, P.E.
Project Manager
GIS Engineering, LLC

Enclosures

Cc: Mr. Oneil Malbrough – GIS
Dustin Malbrough – GIS
Mariann Alvarez – GIS
Ashley Callahan – TPCG

East Coteau / Bayou Blue Sewer Holding Basin Dredging Project TPCG Project No. 16-SEW-14 GIS Project No. 39130-1016/1017						
Bid Evaluation						
Contractor Name:		Merrell Bros, Inc.	Synagro South, LLC	Denali Water Solutions, LLC	Magnolia Dredging & Dock, LLC	Zealous Energy Services
Base Bid:		\$ 256,895.00	\$ 273,000.00	\$ 323,170.00	\$ 394,570.10	\$ 420,460.00
Misc.	Delivered prior to 2:00 p.m.	Y	Y	Y	Y	Y
	Proposal Sealed in an envelope addressed to:					
	Terrebonne Parish Consolidated Government City of Houma Service Complex 301 Plant Road Houma, LA 70363	N/A - Submitted Online	N/A - Submitted Online	N/A - Submitted Online	Y	Y
	Envelope States:					
	East Coteau / Bayou Blue Sewer Holding Basin Dredging Project Parish Project No. 16-SEW-14	N/A - Submitted Online	N/A - Submitted Online	N/A - Submitted Online	Y	Y
License Verification	Licensed Contractor in the State of Louisiana	Y	Y	Y	Y	Yes, but license # provided is not for this company name
	Work Classification: Municipal and Public Works Construction, Heavy Construction, or Minor Classification Dredging	Y	Y	Y	Y	Yes, but license # provided is not for this company name
	Shows License Number on the outside of the Sealed Envelope Containing Bid	N/A - Submitted Online	N/A - Submitted Online	N/A - Submitted Online	Y	Yes, but license # provided is not for this company name
Bid Form	Submitted on Proposal Forms provided In the Contract Documents	Y	Y	Y	Y	Y
	All blank spaces on Bid Forms shall be filled in ink, or typed, in both words and figures (if word and figure disagree the work shall be binding)	Y	Y	Y	Y	Y
	If any corrections are made, the alteration must be crossed out, the correct number written, and the change should be initialed	No Corrections Made	No Corrections Made	No Corrections Made	No Corrections Made	No Corrections Made
	Bids must be signed by the person making such proposal or the proposal must have attached there to a power-of-attorney evidencing authority to sign the proposal in the name of the person for whom it is signed by	Y	Y	Y	Y	Y
	Contractor's State License Number is Typed/Printed below the firm name and signature on the Bid Form	Y	Y	Y	Y	Yes, but license # provided is not for this company name
	Includes verification of receipt of Addenda (the numbers of which filled in on the Proposal Document Form - 1 total	Y	Y	Y	Y	Y
	Includes the address to which communications regarding the Bid are to be directed	Y	Y	Y	Y	Y
Bid Bond	Bid Guaranty in amount of 5% of Proposal Made payable to "Terrebonne Parish Consolidated Government", in the form of a Bid Bond (on Owner Provided Bid Bond Form), Certified Check, or Cashier's Check	Y	Y	Y	Y	Y
	Bid Bond signed by an authorized officer, owner or partner of the bidding firm, or an agent or attorney-in-fact	Y	Y	Y	Y	N
	Bid Bond signed by the surety's agent or attorney-in-fact	Y	Y	Y	Y	Y
	Bid Bond shall be accompanied by a notarized document granting general power of attorney to the surety's signer	Y	Y	Y	Y	Y
	Bid Bond shall be written by a surety or insurance company currently on the US Dept of the Treasury Financial Management Service's list of approved bonding companies which is published annually in the Federal Register, or by a Louisiana domiciled insurance company with at least a A- rating in the latest printing of the A.M. Best's Key Rating Guide to write individual bonds up to 10% of policyholders' surplus as shown in the A.M. Best's Key Rating Guide	Y	Y	Y	Y	Y
Corporation Partnerships	Bids by corporations shall state the full legal corporate name thereof, and the corporate address and the state of incorporation	Y	Y	Y	Y	Y
	Bid by partnerships must indicate the legal name of the partnership, with the official address of the partnership and state of formation of partnership	N/A	N/A	N/A	N/A	N/A
	Evidence of Corporate or Partnership Authority Included in the bid Documents, See Section B	N/A	N/A	N/A	N/A	N/A
Specification Compliance	Contractor in compliance with all requirements of Special Provisions and Technical Spfications	No, Bid Item No. 1 Mob & Demob is above the 10% allowed.	Y	Y	Y	Y

Terrebonne Parish Consolidated Government
East Coteau / Bayou Blue Sewer Holding Basin Dredging Project
TPCG Project No. 16-SEW-14
GIS Project No. 39130-1016/1017

Bid Tabulation

Ref No.	Description	Qty.	UOM	Engineer's Estimate		Zealous Energy Services		Magnolia Dredge & Dock, LLC		Denali Water Solutions		Synagro South, LLC		Merrell Bros, Inc.	
				Unit Price	Unit Price Ext.	Unit Price	Unit Price Ext.	Unit Price	Unit Price Ext.	Unit Price	Unit Price Ext.	Unit Price	Unit Price Ext.	Unit Price	Unit Price Ext.
1	Mobilization & Demobilization	1	LS	\$ 18,200.00	\$ 18,200.00	\$ 18,500.00	\$ 18,500.00	\$ 69,310.10	\$ 69,310.10	\$ 24,885.00	\$ 24,885.00	\$ 27,300.00	\$ 27,300.00	\$ 49,675.00	\$ 49,675.00
2	Dredging, Processing and Handling of Sludge Material	260	Dry Tons	\$ 700.00	\$ 182,000.00	\$ 1,546.00	\$ 401,960.00	\$ 1,251.00	\$ 325,260.00	\$ 1,147.25	\$ 298,285.00	\$ 945.00	\$ 245,700.00	\$ 797.00	\$ 207,220.00
Total Base Bid:				\$	200,200.00	\$	420,460.00	\$	394,570.10	\$	323,170.00	\$	273,000.00	\$	256,895.00



Monday, January 23, 2017

Item Title:

Change Order No. 9 - Emergency Operations Center

Item Summary:

RESOLUTION: Authorizing the execution of Change Order No. 9 for the Construction Agreement for Parish Project No. 14-EOC-03, Terrebonne Parish Emergency Operations Center, Terrebonne Parish, Louisiana

ATTACHMENTS:

Description	Upload Date	Type
Executive Summary	1/18/2017	Executive Summary
Resolution	1/18/2017	Resolution
Backup Material	1/18/2017	Backup Material



EXECUTIVE SUMMARY

(REQUIRED FOR ALL SUBMISSIONS)

PROJECT TITLE	
14-EOC-03	Terrebonne Parish Emergency Operations Center

PROJECT SUMMARY (200 WORDS OR LESS)
Construction of a new Emergency Operations Center

PROJECT PURPOSE & BENEFITS (150 WORDS OR LESS)
Change Order No. 9 consists of a credit to delete the portion of concrete paving adjacent to the future safe room. The change order also adds fourteen (14) days to the construction contract due to change order work and adverse weather in the month of September and November.

TOTAL EXPENDITURE				
Credit of \$773.95				
AMOUNT SHOWN ABOVE IS: (CIRCLE ONE)				
ACTUAL			ESTIMATED	
IS PROJECTALREADY BUDGETED: (CIRCLE ONE)				
N/A	NO	YES	IF YES AMOUNT BUDGETED:	N/A

COUNCIL DISTRICT(S) IMPACTED (CIRCLE ONE)									
<u>PARISHWIDE</u>	1	2	3	4	5	6	7	8	9

Jeanne P. Bray

1/18/2017

Signature

Date

OFFERED BY:
SECONDED BY:

R E S O L U T I O N

A resolution authorizing the execution of Change Order No. 9 for the Construction Agreement for Parish Project No. 14-EOC-03, Terrebonne Parish Emergency Operations Center, Terrebonne Parish, Louisiana.

WHEREAS, the Terrebonne Parish Consolidated Government entered into a contract dated December 28, 2015 with Lamar Contractors, LLC, Recordation Number 1497482, for Parish Project No.14-EOC-03, Terrebonne Parish Emergency Operations Center, Terrebonne Parish, Louisiana, and

WHEREAS, TPCG is desirous of completing the construction of the Emergency Operations Center, and

WHEREAS, in the original plans, a parking lot would be constructed next to the future safe room, and

WHEREAS, the Architect instructed the Contractor to not build a portion of the parking lot adjacent to the future safe room due to conflicts with the location of the future safe room, and

WHEREAS, this change order will decrease the overall contract price by Seven Hundred and Seventy-Three Dollars and Ninety-Five Cents (\$773.95), and

WHEREAS, this change order will add fourteen (14) calendar days to the contract as a result of Change Order No. 9, and

WHEREAS, this Change Order No. 9 has been recommended by the Architect, Houston J. Lirette, Jr, APAC, for this project.

NOW, THEREFORE, BE IT RESOLVED that the Terrebonne Parish Council on behalf of the Terrebonne Parish Consolidated Government, does hereby approve and authorize the execution by Terrebonne Parish President Gordon E. Dove of Change Order No. 9 to the construction agreement with Lamar Contractors, LLC for Parish Project No. 14-EOC-03, Terrebonne Parish Emergency Operations Center, Terrebonne Parish, Louisiana, for an increase to the contract amount of Seven Hundred and Seventy-Three Dollars and Ninety-Five Cents (\$773.95) and fourteen (14) calendar days to the construction contract, and

BE IT FURTHER RESOLVED, that a certified copy of the resolution be forwarded to Architect, Houston J. Lirette, Jr., APAC.

WHEREUPON the motion was put to a vote and the vote thereon was as follows:

YEAS:
NAYS:
NOT VOTING:
ABSENT

And the Chairman declared the resolution adopted on this _____ day of _____, 2017.

* * * * *

I, VENITA H. CHAUVIN, Clerk of the Terrebonne Parish Council, Houma, Louisiana, do hereby certify that the foregoing is a true and correct copy of the RESOLUTION adopted by the Terrebonne Parish Council on _____, 2017, at which meeting a quorum was present.

GIVEN UNDER MY OFFICIAL SIGNATURE AND SEAL OF OFFICE THIS
_____ DAY OF _____, 2017.

VENITA H. CHAUVIN
COUNCIL CLERK
TERREBONNE PARISH COUNCIL



AIA Document G701™ – 2001

Change Order

PROJECT (Name and address): Terrebonne Parish Emergency Operations Center	CHANGE ORDER NUMBER: 009 DATE: 12/22/2016	OWNER: <input type="checkbox"/> ARCHITECT: <input type="checkbox"/> CONTRACTOR: <input type="checkbox"/> FIELD: <input type="checkbox"/> OTHER: <input type="checkbox"/>
TO CONTRACTOR (Name and address): Lamar Contractors, Inc. 481 Judge Edward Dufresne Parkway Luling, LA 70070	ARCHITECT'S PROJECT NUMBER: 14-EOC-03 CONTRACT DATE: 12/28/2015 CONTRACT FOR: General Construction	

THE CONTRACT IS CHANGED AS FOLLOWS:

(Include, where applicable, any undisputed amount attributable to previously executed Construction Change Directives)

- 1) Contractor's Request for Change #21R1 - Electrical Modifications per drawings E-1.1R, E-1.4, E-1.5, E-1.6,
Requesting 2 additional days to contract time for this modification \$3,251.09
- 2) Contractor's Request for Change #24 - Adverse Weather Days for September - 8 days extension to contract time
- 3) Contractor's Request for Change #27 - Credit to delete the portion of concrete paving adjacent to the
future Safe Room (-) \$4,025.04
- 4) Contractor's Request for Change #28 - Adverse Weather Days for November - 4 days extension to contract time.

The original Contract Sum was	\$	5,966,000.00
The net change by previously authorized Change Orders	\$	37,639.43
The Contract Sum prior to this Change Order was	\$	6,003,639.43
The Contract Sum will be decreased by this Change Order in the amount of	\$	773.95
The new Contract Sum including this Change Order will be	\$	6,002,865.48

The Contract Time will be increased by fourteen (14) days.

The date of Substantial Completion as of the date of this Change Order therefore is March 21, 2016

NOTE: This Change Order does not include changes in the Contract Sum, Contract Time or Guaranteed Maximum Price which have been authorized by Construction Change Directive until the cost and time have been agreed upon by both the Owner and Contractor, in which case a Change Order is executed to supersede the Construction Change Directive.

NOT VALID UNTIL SIGNED BY THE ARCHITECT, CONTRACTOR AND OWNER.

Houston J. Lirette, Jr, A Professional Architectural Corporation ARCHITECT (Firm name)	Lamar Contractors, Inc. CONTRACTOR (Firm name)	Terrebonne Parish Consolidated Govt. OWNER (Firm name)
179 Enterprise Drive, Houma, LA 70360 ADDRESS	481 Judge Edward Dufresne Parkway, Luling, LA 70070 ADDRESS	P. O. Box 2768, Houma, LA 70361 ADDRESS
 BY (Signature)	 BY (Signature)	 BY (Signature)
Houston J. Lirette, Jr. (Typed name)	Gary Boudreaux (Typed name)	Gordon E. Dove (Typed name)
12/22/2016 DATE	12/22/16 DATE	 DATE

LAMAR CONTRACTORS, INC

Site Location: Terrebonne Parish "EOC"

Engineer: Houston J. Lirette, Jr.

Date: 10/21/2016

Request For Change No. 21 rev 1- Electrical Modifications per H.L.A. RFC 21 dated 9/1/16

DESCRIPTION	QUANT	MATERIAL UNIT	TOTAL	LABOR UNIT	TOTAL	SUB & OTHER UNIT	TOTAL	TOTAL
C.J.'s Electrical (attached)	1 ls		0		0		1,853	1,853
			0		0		0	0
Per drawings E-1.1R, E-1.4,			0		0		0	0
E-1.5, E-1.6 EOC revised 10/5/16			0		0		0	0
			0		0		0	0
Please advise if acceptable by			0		0		0	0
Wednesday, 10/26/16 as we are			0		0		0	0
in the beginning stages of gypsum			0		0		0	0
board installation and finishing.			0		0		0	0
			0		0		0	0
			0		0		0	0
			0		0		0	0
Supervision	0.28 wk		0	1,860.00	521		0	521
Fuel	0.28 wk	175.00	49		0		0	49
Equipment Bobcat Loader	0.28 wk	495.00	139		0		0	139
Bobcat Excavator	0 wk	600.00	0		0		0	0
Dozer	0 wk	600.00	0		0		0	0
Temp Toilet	0.28 wk	30.00	8		0		0	8
Temp Office	0.28 wk	65.00	18		0		0	18
Temp Storage	0.28 wk	40.00	11		0		0	11
			0		0		0	0
SUB-TOTALS			225.40		520.80		1,852.70	2,598.90
SALES TAX EXEMPT	0 %							0.00
P/R BURDEN @ 41%	0.41 %							213.53
SMALL TOOLS @ 4%	0.04 %							20.83
SUBTOTAL								2,833.26
Lamar OH&P on Subcontractor	0.10 %							185.27
SUBTOTAL								3,018.53
Lamar OH&P on Self Performed	0.15 %							147.08
SUBTOTAL								3,165.61
Bond & Insurance	0.027 %							85.47
GRAND TOTAL								3,251.09

This office is requesting an additonal (2) Two Days be added to the Contract.

Please advise this office in (10) Ten Days whether this RFC has been approved.

Delay in approval will require additional time be added to the contract.



C. J.'S ELECTRICAL SERVICE, INC.

253 Trinity Lane Gray, LA 70359 ♦ 985-868-6268 ♦ Toll Free 888-407-7141 ♦ Fax 985-851-7010

cjselectricalsve@bellsouth.net

PROPOSAL # 16-9021 Change Order Revised

October 21, 2016

Lamar Contractors
481 Judge Edward Dufresne Parkway
Luling, LA 70070

Attention: John Desselle

Re: Terrebonne Parish E.O.C- RFC #21 *REVISION 1*

Dear John:

We are pleased to submit our change order proposal per RFC #21. This proposal includes:

<u>Qty</u>	<u>Description</u>	<u>Unit Price</u>	<u>+15%</u>	<u>Extended Price</u>
70'	2" Emt	2.27	.34	182.70
4	2" Emt elbow	7.08	1.07	32.60
2	2" Emt connector	2.70	.41	6.22
16	2" Emt coupling	2.06	.31	37.92
12	2" Emt strap	3.28	.50	45.36
2	2" plastic bushing	2.34	.36	5.40
60'	1" Emt	.95	.15	660.00
3	1" Emt Elbow	3.45	.52	11.91
2	1" Emt connector	.84	.13	1.94
12	1" Emt coupling	.27	.04	3.72
10	1" Emt strap	1.05	.16	12.10
2	1" plastic bushing	1.20	.18	2.76
30'	½" Emt	.32	.05	11.10
4	½" Emt connectors	.27	.04	1.24
4	½" Emt coupling	.21	.04	1.00
6	½" Emt strap	.17	.03	1.20
3	4" sq 2 1/8" deep J-box	3.16	.48	10.92
2	¾" raised ring	.58	.09	1.34
1	4" sq raised ring	.40	.06	.46
2	Box brace	3.10	.47	7.14
1	Duplex receptacle	3.50	.53	4.03
1	30a, 2p, 3-wire receptacle	25.30	3.80	29.10

Page 2

October 21, 2016

Re: Terrebonne Parish E.O.C- RFC #21

<u>Qty</u>	<u>Description</u>	<u>Unit Price</u>	<u>+15%</u>	<u>Extended Price</u>
2	Receptacle	1.00	.15	2.30
300'	#10 wire	.15	.03	54.00
300'	#8 wire	.26	.04	90.00
1	Misc.	26.90	4.04	30.94
16	Labor hr.	75.00	-	1,200.00
Total Cost:				\$1,852.70

****Note:** We request that two (2) days be added to the contract time for the additional work added in this proposal.

C. J.'s Electrical Service, Inc.

Greg Marie/sl

Greg Marie

Vice President

GCM: sl

Proposal is good for 30 days.

If this proposal is accepted, please sign, date and return to our office by fax or email.

Accepted By: _____

Date: _____

Print Name: _____

Order #: _____

LAMAR CONTRACTORS, INC

Site Location: Terrebonne Parish "EOC"

Engineer: Houston J. Lirette, Jr.

Date: 10/13/2016

Request For Change No. 24 - Request for Additional Days due to Rain_Adverse Weather during September 2016

DESCRIPTION	QUANT	MATERIAL		LABOR		SUB & OTHER		TOTAL
		UNIT	TOTAL	UNIT	TOTAL	UNIT	TOTAL	
August of 2016 had the			0		0		0	0
following Adverse Weather Days			0		0		0	0
RAIN -September 3, 5, 6, 16,			0		0		0	0
& 26	5 day		0		0		0	0
TO WET - September 7, 12 & 17			0		0		0	0
	3 day		0		0		0	0
			0		0		0	0
			0		0		0	0
			0		0		0	0
			0		0		0	0
			0		0		0	0
			0		0		0	0
**AccuWeather Reports (attach)			0		0		0	0
Supervision	0 wk		0	1,860.00	0		0	0
Fuel	0 wk	175.00	0		0		0	0
Equipment Bobcat Loader	0 wk	495.00	0		0		0	0
Bobcat Excavator	0 wk	600.00	0		0		0	0
Dozer	0 wk	600.00	0		0		0	0
Temp Toilet	0 wk	30.00	0		0		0	0
Temp Office	0 wk	65.00	0		0		0	0
Temp Storage	0 wk	40.00	0		0		0	0
			0		0		0	0
SUB-TOTALS			0.00		0.00		0.00	0.00
SALES TAX EXEMPT	0 %							0.00
P/R BURDEN @ 41%	0.41 %							0.00
SMALL TOOLS @ 4%	0.04 %							0.00
SUBTOTAL								0.00
Lamar OH&P on Subcontractor	0.10 %							0.00
SUBTOTAL								0.00
Lamar OH&P on Self Performed	0.15 %							0.00
SUBTOTAL								0.00
Bond & Insurance	0.027 %							0.00
GRAND TOTAL								0.00

This office is requesting an additonal (8) Eight Days be added to the Contract.

Please advise this office in (10) Ten Days whether this RFC has been approved.

Delay in approval will require additional time be added to the contract.

Help people affected by Hurricane Matthew

Donate Now



Elevate your kitchen savings event.
Get up to a \$300 mail-in rebate on select Bosch
wall ovens and cooktops.
Offer valid July 1 - December 31, 2016

Learn More



World > North America > United States > Louisiana > Gray

ENGLISH (US), °F

Gray, LA

Follow us on

United States Weather	Gray, LA Local Weather	86°F	Personalized Forecasts: Allergies
Now	Weekend	Extended	Month
		Radar	MinuteCast

Watch Videos

August 2016	View:	September	2016	October 2016
Date	H/L	Precip	Snow	Forecast
Thu 9/1	94°/74°	0 IN	0 IN	90°/72°
Fri 9/2	92°/75°	0.01 IN	0 IN	90°/72°
Sat 9/3	91°/73°	0.60 IN	0 IN	90°/72°
Sun 9/4	87°/74°	0.37 IN	0 IN	90°/72°
Mon 9/5	83°/74°	0.90 IN	0 IN	90°/72°
Tue 9/6	89°/74°	0.36 IN	0 IN	90°/71°
Wed 9/7	88°/73°	0.03 IN	0 IN	89°/71°
Thu 9/8	90°/70°	0 IN	0 IN	89°/71°
Fri 9/9	87°/72°	0.15 IN	0 IN	89°/71°
Sat 9/10	90°/73°	0.12 IN	0 IN	89°/70°
Sun 9/11	89°/73°	0.76 IN	0 IN	89°/70°
Mon 9/12	88°/72°	0.07 IN	0 IN	89°/70°
Tue 9/13	87°/74°	0.18 IN	0 IN	88°/70°
Wed 9/14	88°/74°	0.16 IN	0 IN	88°/70°
Thu 9/15	86°/73°	0.11 IN	0 IN	88°/69°
Fri 9/16	83°/75°	0.84 IN	0 IN	88°/69°
Sat 9/17	84°/74°	0.22 IN	0 IN	88°/69°
Sun 9/18	85°/73°	0.13 IN	0 IN	87°/68°
Mon 9/19	93°/74°	0 IN	0 IN	87°/68°
Tue 9/20	92°/71°	0 IN	0 IN	87°/68°
Wed 9/21	92°/71°	0.02 IN	0 IN	87°/67°
Thu 9/22	90°/72°	0 IN	0 IN	86°/67°
Fri 9/23	90°/72°	0.16 IN	0 IN	86°/67°

Rain

Rain
Rain
Wet

Wet

Rain
Wet

Date	Hi/Lo	Precip	Snow	Forecast	Avg Hi / LO
Sat 9/24	91°/71°	0.04 IN	0 IN		86°/66°
Sun 9/25	90°/71°	0.04 IN	0 IN		86°/66°
<i>Rain</i> Mon 9/26	91°/70°	0.29 IN	0 IN		86°/66°
Tue 9/27	88°/70°	0.07 IN	0 IN		85°/65°
Wed 9/28	88°/68°	0 IN	0 IN		85°/65°
Thu 9/29	86°/66°	0 IN	0 IN		85°/64°
Fri 9/30	82°/53°	0 IN	0 IN		85°/64°

August 2016

October 2016

Temperature Graph September 2016

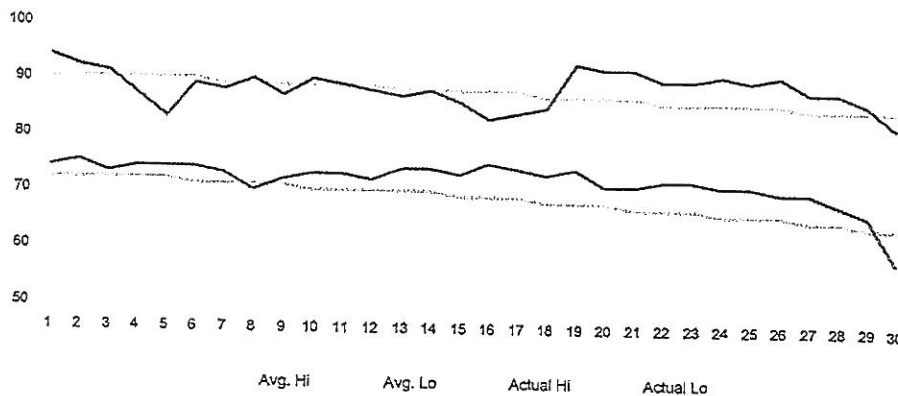

	Actual	Normal	Departure	Record
High	88°	88°		N/A° (N/A)
Low	72°	69°		N/A° (N/A)
Average	80°	78°	+2°	
Precip	5.63 in	6.11 in	-0.48 in	
Snow	0 in			

LAMAR CONTRACTORS, INC

Site Location: Terrebonne Parish "EOC"

Engineer: Houston J. Lirette, Jr.

Date: 11/10/2016

Request For Change No. 27 - Work Changes Proposal Request No. 7

DESCRIPTION	QUANT	MATERIAL		LABOR		SUB & OTHER		TOTAL
		UNIT	TOTAL	UNIT	TOTAL	UNIT	TOTAL	
Onshore Materials - No Charge			0		0		0	0
LaMay Group - No Charge	1 ls		0		0		68	68
			0		0		0	0
Form Paving	15 sf	-1.70	-26		0		0	-26
Concrete	24 cy	-104.00	-2,496		0		0	-2,496
Finishing	1280 sf		0		0	-1.00	-1,280	-1,280
Concrete Curing	1280 sf	-0.02	-26	-0.02	-26		0	-51
Sawcut	35 lf		0		0	-2.00	-70	-70
Sealant	35 lf		0		0	-1.50	-53	-53
			0		0		0	0
			0		0		0	0
			0		0		0	0
Supervision	0 wk		0	1,860.00	0		0	0
Fuel	0 wk	175.00	0		0		0	0
Equipment Bobcat Loader	0 wk	495.00	0		0		0	0
Bobcat Excavator	0 wk	600.00	0		0		0	0
Dozer	0 wk	600.00	0		0		0	0
Temp Toilet	0 wk	30.00	0		0		0	0
Temp Office	0 wk	65.00	0		0		0	0
Temp Storage	0 wk	40.00	0		0		0	0
			0		0		0	0
SUB-TOTALS			-2,547.10		-25.60		-1,335.00	-3,907.70
SALES TAX EXEMPT	0 %							0.00
P/R BURDEN @ 41%	0.41 %							-10.50
SMALL TOOLS @ 4%	0.04 %							-1.02
SUBTOTAL								-3,919.22
Lamar OH&P on Subcontractor	0.10 %							0.00
SUBTOTAL								-3,919.22
Lamar OH&P on Self Performed	0.15 %							0.00
SUBTOTAL								-3,919.22
Bond & Insurance	0.027 %							-105.82
GRAND TOTAL								-4,025.04

This office is requesting an additional (0) Zero Days be added to the Contract.

Please advise this office in (10) Ten Days whether this RFC has been approved.

Delay in approval will require additional time be added to the contract.

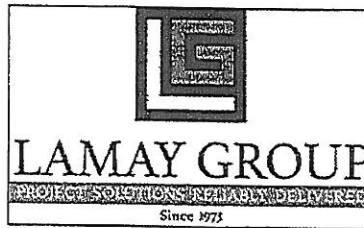

QUOTE PREPARED BY:

PROPOSAL # 15-4435R2

SUBMITTED TO: Lamar Contractors, LLC	ATTENTION: John Desselle	DATE: 11/7/16
STREET/ P. O. BOX:	PROJECT: Terrebonne Parish Emergency Operations Center	
CITY, STATE AND ZIP CODE:		
PHONE:	LOCATION: Terrebonne Parish	
EMAIL: j.desselle@lamarcontractors.com		
FAX:		

ALL QUANTITIES ARE APPROXIMATE			
ITEM DESCRIPTION:	UNIT	QUANTITY	
Hydromulching - Common Bermuda	\$2,250.00 per acre	0.03 acres	\$67.50
→ 1 Mobilization included			
→ Sod Excluded			
			\$67.50

LaMay Group will furnish materials and labor in a professional manner according project plans and specifications.

CLARIFICATIONS:

- 1) Mulch (Vegetative) NO ASPHALT MULCH
- 2) Water must be available on or near site at no cost to LaMay Group for our work
- 3) Testing of soil for seeded areas excluded
- 4) Watering & maintenance of Seeded & Sodded Areas excluded
- 5) Agricultural Lime Excluded, unless specified
- 6) Maintenance & removal of temporary erosion control items excluded
- 7) Debris/rock/concrete shard removal excluded
- 8) Brooms not provided for removal of mulch on paved surfaces
- 9) Traffic control by others
- 10) Topsoil to grade by others
- 11) Clearing, Grubbing, Removal and Layout by others prior to LaMay mobilizing
- 12) In order to accommodate additions/deletions of quantities, unit prices prevail
- 13) Bonding will be provided at cost if required
- 14) Additional insurance, above standard DOTD requirements, will be provided at cost
- 15) This proposal may be withdrawn by LaMay Group if not accepted within 45 days

Thank you for considering our quote in your bid.

Brandon Trahan, Johnny LaGrone, Jimmy LaGrone, Sanders Castille & Rhonda Butler

LAMAY GROUP

3296 Cotton Gin Rd. • PO Box 279 Livonia, LA 70755
P 225.637.3141 • F 225.637.3170 • E contact@lamaygroup.com • W www.lamaygroup.com
General Contractor's License 36764 • Landscape Horticulturist 16-2210 • Irrigation 16-072 • Arborist 16-9089 • Ground Applicator

AIA® Document G709™ – 2001

Work Changes Proposal Request

PROJECT (Name and address):
Terrebonne Parish Emergency
Operations Center

PROPOSAL REQUEST NUMBER: 007

OWNER: ☐

ARCHITECT: ☐

CONSULTANT: ☐

CONTRACTOR: ☐

FIELD: ☐

OTHER: ☐

DATE OF ISSUANCE: 10/4/2016

CONTRACT FOR: General Construction

CONTRACT DATE: 12/28/2015

OWNER (Name and address):
Terrebonne Parish Consolidated
Govt.
P. O. Box 2768
Houma, LA 70361

FROM ARCHITECT (Name and
address):
Houston J. Lirette, Jr., A Professional
Architectural Corporation
179 Enterprise Drive
Houma, LA 70360

ARCHITECT'S PROJECT NUMBER:
14-EOC-03

TO CONTRACTOR (Name and
address):
Lamar Contractors, Inc.
481 Judge Edward Dufresne Parkway
Luling, LA 70070

Please submit an itemized proposal for changes in the Contract Sum and Contract Time for proposed modifications to the Contract Documents described herein. Within ten (10) days, the Contractor must submit this proposal or notify the Architect, in writing, of the date on which proposal submission is anticipated.

THIS IS NOT A CHANGE ORDER, A CONSTRUCTION CHANGE DIRECTIVE OR A DIRECTION TO PROCEED WITH THE WORK DESCRIBED IN THE PROPOSED MODIFICATIONS.

DESCRIPTION (Insert a written description of the Work):

Please provide credit to delete the portion of concrete paving adjacent to the future Safe Room and adjust the elevations as per the attached sketch.

ATTACHMENTS (List attached documents that support description):

Drawing by Milford & Associates dated 9/28/2016

REQUESTED BY THE ARCHITECT:

(Signature)

Houston J. Lirette, Jr.
(Printed name and title)

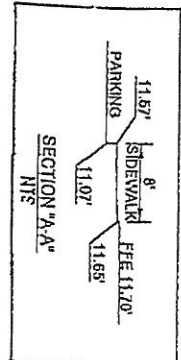

P R E L I M I N A R Y

This drawing is not to be used for construction, bidding, recordation, conveyance, sales or as the basis for the issuance of a permit. This preliminary drawing has been prepared by F. E. Milford, III, LA #30701

MULTI-AGENCY SAFE ROOM
105 GOVERNMENT STREET
TERREBONNE PARISH, LOUISIANA

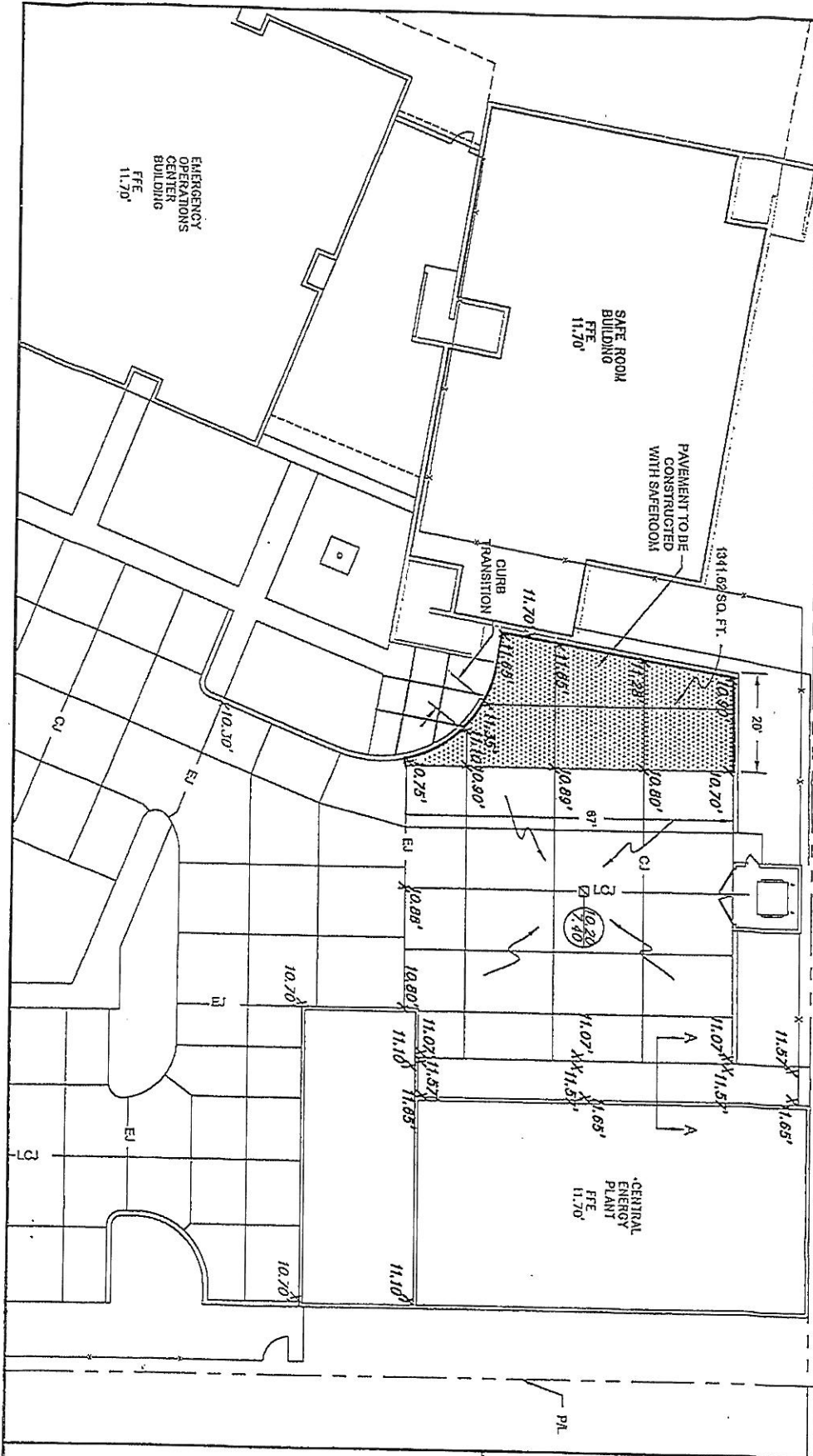

MILFORD & ASSOCIATES, INC. CONSULTING ENGINEERS HOUMA, LOUISIANA	DRAWN BY : KKT	CHECKED BY : F.E.M. III	DATE : 28SEPT16
	JOB NO. : 28SEPT16	CAD NO. : 1439-JOINT	SCALE : 1" = 20'

LAMAR CONTRACTORS, INC

Site Location: Terrebonne Parish "EOC"

Engineer: Houston J. Lirette, Jr.

Date: 12/7/2016

Request For Change No. 28 - Request for Additional Days due to Rain_Adverse Weather for November 2016

DESCRIPTION	QUANT	MATERIAL UNIT TOTAL	LABOR UNIT TOTAL	SUB & OTHER UNIT TOTAL	TOTAL
November of 2016 had the					0
Following Adverse Weather Days					0
RAIN - 7, 8 & 30	3 day				0
					0
TO WET - 9	1 day				0
					0
					0
					0
					0
					0
					0
					0
*AccuWeather Reports (attach)					0
Supervision	0 wk		1,860.00		0
Fuel	0 wk	175.00			0
Equipment Bobcat Loader	0 wk	495.00			0
Bobcat Excavator	0 wk	600.00			0
Dozer	0 wk	600.00			0
Temp Toilet	0 wk	30.00			0
Temp Office	0 wk	65.00			0
Temp Storage	0 wk	40.00			0
					0
SUB-TOTALS			0.00		0.00
SALES TAX EXEMPT	0 %				0.00
LABOR BURDEN @ 41%	0.41 %				0.00
SMALL TOOLS @ 4%	0.04 %				0.00
UBTOTAL					0.00
Lamar OH&P on Subcontractor	0.10 %				0.00
UBTOTAL					0.00
Lamar OH&P on Self Performed	0.15 %				0.00
UBTOTAL					0.00
Bond & Insurance	0.027 %				0.00
GRAND TOTAL					0.00

This office is requesting an additional (4) Four Days be added to the Contract.

Please advise this office in (10) Ten Days whether this RFC has been approved.

Delay in approval will require additional time be added to the contract.

Gray, LA

Follow us on

United States Weather		Gray, LA Local Weather		56°F	Personalized Forecasts: Cold & Flu	
Now	Weekend	Extended	Month	Radar	MinuteCast®	Watch Videos

October 2016	View:	November	2016	December 2016	
Date	Hi/Lo	Precip	Snow	Forecast	Avg. Hi / LO
Tue 11/1	85°/59°	0 IN	0 IN		77°/55°
Wed 11/2	85°/67°	0 IN	0 IN		76°/54°
Thu 11/3	85°/65°	0 IN	0 IN		76°/54°
Fri 11/4	86°/65°	0 IN	0 IN		76°/54°
Sat 11/5	80°/59°	0 IN	0 IN		76°/54°
Sun 11/6	79°/62°	0 IN	0 IN		75°/54°
Mon 11/7	75°/63°	0.61 IN	0 IN		75°/54°
Tue 11/8	75°/64°	0.18 IN	0 IN		75°/53°
Wed 11/9	73°/60°	0.04 IN	0 IN		74°/53°
Thu 11/10	74°/53°	0 IN	0 IN		74°/53°
Fri 11/11	69°/51°	0 IN	0 IN		74°/53°
Sat 11/12	75°/48°	0 IN	0 IN		74°/52°
Sun 11/13	69°/46°	0 IN	0 IN		73°/52°
Mon 11/14	73°/46°	0 IN	0 IN		73°/52°
Tue 11/15	77°/48°	0 IN	0 IN		73°/52°
Wed 11/16	79°/53°	0 IN	0 IN		73°/51°
Thu 11/17	80°/50°	0 IN	0 IN		72°/51°
Fri 11/18	80°/58°	0 IN	0 IN		72°/51°
Sat 11/19	65°/44°	0.04 IN	0 IN		72°/51°
Sun 11/20	64°/38°	0 IN	0 IN		72°/50°
Mon 11/21	68°/35°	0 IN	0 IN		71°/50°

Rain
Rain
Wet

FREE
AT&T Trek™
2 HD tablet
with 2-year agreement



Shop Now



*Get a new 2-year agreement with
qual. vaco & data plan.
Activation, upgrade, early
termination & other fees
may apply. Online
only. See offer details.

Date	H/L	Precip	Snow	Forecast	Avg. H/L
Tue 11/22	74°/41°	0 IN	0 IN		71°/50°
Wed 11/23	79°/58°	0.02 IN	0 IN		71°/50°
Thu 11/24	73°/56°	0 IN	0 IN		70°/49°
Fri 11/25	76°/54°	0 IN	0 IN		70°/49°
Sat 11/26	68°/45°	0 IN	0 IN		70°/49°
Sun 11/27	70°/40°	0 IN	0 IN		70°/48°
Mon 11/28	77°/55°	0.08 IN	0 IN		69°/48°
Tue 11/29	81°/70°	0.04 IN	0 IN		69°/48°
Wed 11/30	74°/47°	0.35 IN	0 IN		69°/48°

Rain

October 2016

December 2016

Temperature Graph November 2016



Avg. Hi Avg. Lo Actual Hi Actual Lo

	Actual	Normal	Departure	Record
High	76°	73°		N/A° (N/A)
Low	53°	51°		N/A° (N/A)
Average	64°	62°	+2°	
Precip	1.36 in	4.03 in	-2.67 in	
Snow	0 in			

Qlik®

Meet
Qlik® Sense

Drag. Drop.
Visualize.
(It's that easy!)

Free
Download

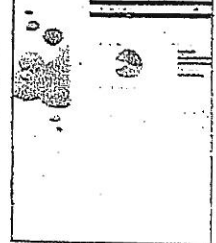



Monday, January 23, 2017

Item Title:

Appointment of All South Consulting Engineers to Sylvia Street Drainage Improvements Project Phase 3A

Item Summary:

RESOLUTION: Ratifying the appointment of the firm of All South Consulting Engineers, LLC to provide professional services for the Sylvia Street Drainage Improvements Project Phase 3A, Project No. 17-DRA-04; and authorizing the execution of an agreement for these services.

ATTACHMENTS:

Description	Upload Date	Type
Executive Summary	1/18/2017	Executive Summary
Resolution	1/18/2017	Resolution



EXECUTIVE SUMMARY

(REQUIRED FOR ALL SUBMISSIONS)

PROJECT TITLE	
17-DRA-04	Sylvia Street Drainage Improvements Project Phase 3A

PROJECT SUMMARY (200 WORDS OR LESS)
To appoint All South Consulting Engineers, LLC to provide engineering services for the Sylvia Street Drainage Improvements Project Phase 3A.

PROJECT PURPOSE & BENEFITS (150 WORDS OR LESS)
The purpose of this appointment is to provide engineering services for drainage improvements around Sylvia Street.

TOTAL EXPENDITURE	
N/A	
AMOUNT SHOWN ABOVE IS: (CIRCLE ONE)	
ACTUAL	ESTIMATED
IS PROJECTALREADY BUDGETED: (CIRCLE ONE)	
<u>N/A</u>	NO
YES	IF YES AMOUNT BUDGETED:
N/A	

COUNCIL DISTRICT(S) IMPACTED (CIRCLE ONE)										
PARISHWIDE	1	2	3	4	<u>5</u>	6	7	8	9	

Jeanne P. Bray

01/18/2017

Signature

Date

OFFERED BY:
SECONDED BY:

RESOLUTION

A resolution ratifying the appointment of the firm of All South Consulting Engineers, LLC to provide professional services for the **Sylvia Street Drainage Improvements Project Phase 3A, Project No. 17-DRA-04**; and authorizing the execution of an agreement for these services.

WHEREAS, Terrebonne Parish Consolidated Government is desirous of improving the drainage in the Sylvia Street area, and

WHEREAS, the Terrebonne Parish Consolidated Government is desirous of appointing a firm to provide professional services for the project entitled **Sylvia Street Drainage Improvements Project Phase 3A**, and

WHEREAS, the firm of All South Consulting Engineers, LLC has been selected by Terrebonne Parish President Gordon E. Dove to provide the professional services relative to said project, and

NOW, THEREFORE BE IT RESOLVED that the Terrebonne Parish Council does hereby ratify the appointment of the firm of All South Consulting Engineers, LLC by Terrebonne Parish President Gordon E. Dove for professional services for the Sylvia Street Drainage Improvements Project Phase 3A, and

BE IT FURTHER RESOLVED that the Terrebonne Parish Council, on behalf of the Terrebonne Parish Consolidated Government, does hereby authorize the execution of an agreement with the firm of All South Consulting Engineers, LLC by Terrebonne Parish President Gordon E. Dove.

THERE WAS RECORDED:

YEAS:
NAYS:
NOT VOTING:
ABSENT

And the Chairman declared the resolution adopted on this _____ day of _____, 2017.

* * * * *

I, VENITA CHAUVIN, Clerk of the Terrebonne Parish Council, Houma, Louisiana, do hereby certify that the foregoing is a true and correct copy of the RESOLUTION adopted by the Terrebonne Parish Council on _____, 2017, at which meeting a quorum was present.

GIVEN UNDER MY OFFICIAL SIGNATURE AND SEAL OF OFFICE THIS _____ DAY OF _____, 2017.

VENITA CHAUVIN, CLERK
TERREBONNE PARISH COUNCIL

Category Number:
Item Number: 11.



Monday, January 23, 2017

Item Title:

Appraisal services (Logan Babin) for Susie Canal

Item Summary:

RESOLUTION: Ratifying the appointment of the firm of Logan H. Babin Real Estate & Appraisals, to provide appraisal services for the Susie Canal Levee Improvements Project (CDBG); Parish Project No. 10-LEV-31 and authorizing execution of an agreement or Purchase Order for these services.

ATTACHMENTS:

Description	Upload Date	Type
Executive Summary	1/18/2017	Executive Summary
Resolution	1/18/2017	Resolution



EXECUTIVE SUMMARY

(REQUIRED FOR ALL SUBMISSIONS)

PROJECT TITLE
Susie Canal Levee Improvement Project (CDBG); Parish Project 10-LEV-31

PROJECT SUMMARY (200 WORDS OR LESS)
To appoint Logan H. Babin Real Estate & Appraisals to provide appraisal services for the Susie Canal Levee Improvements Project (CDBG); Parish Project No. 10-LEV-31.

PROJECT PURPOSE & BENEFITS (150 WORDS OR LESS)
The purpose of this resolution is to appoint the appraisal services to the firm Logan H. Babin Real Estate & Appraisals, which has been selected through the Request for Qualifications / Request for Proposals Process (RFQ/RFP), to provide required appraisal services.

TOTAL EXPENDITURE		
\$25,000		
AMOUNT SHOWN ABOVE IS: (CIRCLE ONE)		
<u>ACTUAL</u>	ESTIMATED	
IS PROJECTALREADY BUDGETED: (CIRCLE ONE)		
N/A	NO	<u>YES</u>
IF YES AMOUNT BUDGETED:		\$25,000

COUNCIL DISTRICT(S) IMPACTED (CIRCLE ONE)									
PARISHWIDE	1	2	3	4	5	6	<u>7</u>	8	9

Jeanne P. Bray

01/18/2017

Signature

Date

OFFERED BY:
SECONDED BY:

RESOLUTION

A resolution ratifying the appointment of the firm of Logan H. Babin Real Estate & Appraisals, to provide appraisal services for the **Susie Canal Levee Improvements Project (CDBG); Parish Project No. 10-LEV-31** and authorizing execution of an agreement or Purchase Order for these services.

WHEREAS, the Terrebonne Parish Consolidated Government wishes to provide appraisal services for the Susie Canal Levee Improvements Project (CDBG); Parish Project No. 10-LEV-31, and

WHEREAS, the firm of Logan H. Babin Real Estate & Appraisals has been selected through the Request for Qualifications / Request for Proposals process to provide the required services for the Susie Canal Levee Improvements Project (CDBG) Project; Parish Project No. 10-LEV-31, and

NOW, THEREFORE BE IT RESOLVED that the Terrebonne Parish Council does hereby ratify the appointment of the firm of Logan H. Babin Real Estate & Appraisals, by Terrebonne Parish President Gordon Dove for professional appraisal services for the Susie Canal Levee Improvements Project (CDBG); Parish Project No. 10-LEV-31; and

BE IT FURTHER RESOLVED that the Terrebonne Parish Council, on behalf of the Terrebonne Parish Consolidated Government, does hereby authorize the execution of an agreement or a purchase order with the firm of Logan H. Babin Real Estate & Appraisals, by Terrebonne Parish President Gordon Dove, for the Susie Canal Levee Improvements Project (CDBG); Parish Project No. 10-LEV-31.

THERE WAS RECORDED:

YEAS:

NAYS:

ABSENT & NOT VOTING:

And the Chairman declared the resolution adopted on this _____ day of _____, 2017.

* * * * *

I, VENITA CHAUVIN, Clerk of the Terrebonne Parish Council, Houma, Louisiana, do hereby certify that the foregoing is a true and correct copy of the RESOLUTION adopted by the Terrebonne Parish Council on _____, 2017, at which meeting a quorum was present.

GIVEN UNDER MY OFFICIAL SIGNATURE AND SEAL OF OFFICE THIS _____ DAY OF _____, 2017.

VENITA CHAUVIN, CLERK
TERREBONNE PARISH COUNCIL

Category Number:
Item Number: 12.



Monday, January 23, 2017

Item Title:

Amend 01 - Petit Caillou Drainage

Item Summary:

RESOLUTION: Providing approval of Amendment No. 1 to the Engineering Agreement for Parish Project No. **16-DRA-25, Petit Caillou Drainage Project**, Terrebonne Parish, Louisiana.

ATTACHMENTS:

Description	Upload Date	Type
Executive Summary	1/19/2017	Cover Memo
Resolution	1/19/2017	Resolution
Backup Material	1/19/2017	Backup Material



EXECUTIVE SUMMARY

(REQUIRED FOR ALL SUBMISSIONS)

PROJECT TITLE	
16-DRA-25	Petit Caillou Drainage Project

PROJECT SUMMARY (200 WORDS OR LESS)
To provide engineering services for the Petit Caillou Drainage Project.

PROJECT PURPOSE & BENEFITS (150 WORDS OR LESS)
The purpose of this amendment is to continue engineering services for the design of the Petit Caillou Drainage Project

TOTAL EXPENDITURE				
\$642,044.43				
AMOUNT SHOWN ABOVE IS: (CIRCLE ONE)				
ACTUAL			ESTIMATED	
IS PROJECTALREADY BUDGETED: (CIRCLE ONE)				
N/A	NO	YES	IF YES AMOUNT BUDGETED:	N/A

COUNCIL DISTRICT(S) IMPACTED (CIRCLE ONE)									
PARISHWIDE	1	2	3	4	5	6	7	8	9

Jeanne P. Bray

01/18/2017

Signature

Date

OFFERED BY:
SECONDED BY:

RESOLUTION

A resolution providing approval of Amendment No. 1 to the Engineering Agreement for Parish Project No. **16-DRA-25, Petit Caillou Drainage Project**, Terrebonne Parish, Louisiana.

WHEREAS, the Terrebonne Parish Consolidated Government did enter into an original engineering agreement with All South Consulting Engineers, L.L.C. dated May 31, 2016, recordation number 1508193, for the Petit Caillou Drainage Project identified as Parish Project 16-DRA-25, and

WHEREAS, the Engineering Agreement between OWNER and ENGINEER provides for certain limitations for Basic Services and specific Additional Services, and

WHEREAS, the Study and Report Phase was approved in the original engineering agreement, and

WHEREAS, TPCG is desirous of continuing with the design of the Petit Caillou Drainage Project, and

WHEREAS, GIS requested an amendment to their existing contract to provide services to continue with the design of the project, and

WHEREAS, the Engineer must receive written authorization from TPCG before beginning the design of any phase of work, and

WHEREAS, the TPCG is desirous of having these services continued so that there is a need for additional funds to be added to the contract, and

WHEREAS, this above work will increase the basic services section of the contract by \$402,700.00 and the additional services section by \$300,544.43.

NOW, THEREFORE BE IT RESOLVED that the Terrebonne Parish Council, on behalf of the Terrebonne Parish Consolidated Government, does hereby approve this Amendment No. 1 to the Engineering Agreement for an increase of \$402,700.00 in Basic Services and \$300,544.43 in additional services, and authorizes Parish President Gordon E. Dove to execute this Amendment No. 1 to the Engineering Agreement for the Petit Caillou Drainage Project Parish Project No. 16-DRA-25, with GIS Engineering, LLC, and

BE IT FURTHER RESOLVED that a certified copy of the resolution be forwarded to the Engineer, GIS Engineering, LLC.

THERE WAS RECORDED:

YEAS:

NAYS:

NOT VOTING:

ABSENT

And the Chairman declared the resolution adopted on this _____ day of _____, 2017.

* * * * *

I, VENITA H. CHAUVIN, Clerk of the Terrebonne Parish Council, Houma, Louisiana, do hereby certify that the foregoing is a true and correct copy of the RESOLUTION adopted by the Terrebonne Parish Council on _____, 2017, at which meeting a quorum was present.

GIVEN UNDER MY OFFICIAL SIGNATURE AND SEAL OF OFFICE THIS _____ DAY OF _____, 2017.

VENITA H. CHAUVIN, CLERK
TERREBONNE PARISH COUNCIL

**AMENDMENT NO. 1
TO
ENGINEERING AGREEMENT**

THIS AMENDMENT NO. 1, hereafter sometimes referred to as "AGREEMENT", made and entered into this _____ day of _____, 2017;

BY AND BETWEEN:

TERREBONNE PARISH CONSOLIDATED GOVERNMENT, (TPCG), a political subdivision of the State of Louisiana, represented herein by its duly authorized President, Gordon E. Dove (hereafter sometimes referred to as "OWNER"), and

GIS ENGINEERING, LLC, represented herein by Dustin Malbrough, duly authorized Principal (hereafter sometimes referred to as "ENGINEER"):

is a revision pursuant to 5.1.1 (Basic Services) and 5.1.2 (Additional Services) to the ENGINEERING AGREEMENT dated May 31, 2016, for professional engineering services between the OWNER and ENGINEER.

WITNESSED:

WHEREAS, the Terrebonne Parish Consolidated Government did enter into an original engineering contract dated May 31, 2016, to the entitled **Petit Caillou Drainage Project**, identified as **Parish Project No. 16-DRA-25**, and

WHEREAS, the Engineering Agreement between OWNER and ENGINEER provides for certain limitations for Basic Services and specific Additional Services, and

WHEREAS, the Study and Report Phase was approved in the original engineering agreement, and

WHEREAS, TPCG is desirous of continuing with the design of the Petit Caillou Drainage Project, and

WHEREAS, GIS requested an amendment to their existing contract to provide services to continue with the design of the project, and

WHEREAS, the TPCG is desirous of having these services continued so that there is a need for additional funds to be added to the contract for an increase in the upset limit for these services, and

NOW THEREFORE, be it understood and agreed by the parties hereto amend the contract as follows:

Amend Section 5, Paragraph 5.1.1, to read as follows:

5.1.1 For Basic Services. OWNER shall pay ENGINEER for Basic Services rendered under Section 1 (as amended and supplemented by Exhibit "A", "Further Description of Basic Engineering Services and Related Matters") as follows:

Study and Report - \$44,495.00
Basic Services - \$402,700.00

Written authorization from OWNER must be obtain before beginning the design of any phase of work.

Amend Section 5, Paragraph 5.1.2.1, to read as follows:

5.1.2.1 General. For Additional Services and Reimbursable Expenses rendered under Paragraphs 2.1.1 through 2.1.17, inclusive (Except services covered by Paragraph 2.1.7 and services as a consultant or witness under 2.1.16), on the basis of Exhibit "D", "Current Rate Schedule - 2016". At this time the following additional services are anticipated and Estimated Costs shown below are recommended for budgetary considerations.

<u>Description</u>	<u>Current Limit</u>	<u>Increase/Decrease</u>	<u>New Limit</u>
Existing Conditions Gap Analysis	\$13,320.00	\$0.00	\$13,320.00
Drainage Basin Research & Analysis	\$19,730.00	\$0.00	\$19,730.00
Engineering Survey Coordination	\$2,700.00	\$0.00	\$2,700.00
Surveying	\$17,250.00	(\$8,855.57)	\$8,394.43
Phase 1 ESA	\$5,700.00	\$0.00	\$5,700.00
Permitting/Permitting Coordination	\$0.00	\$30,575.00	\$30,575.00
Topographic/Hydrographic Surveys	\$0.00	\$12,730.00	\$12,730.00
Geotechnical Engineering			
Coordination	<u>\$0.00</u>	<u>\$3,800.00</u>	<u>\$3,800.00</u>
Total	\$58,700.00	\$38,249.43	\$96,949.43

Amend Section 5, Paragraph 5.1.2.2, to reads as follows:

5.1.2.2 Special Consultants. For services and reimbursable expenses incurred for coordination of special consultants employed by ENGINEER pursuant to Paragraph 2.1.1 or 2.1.17, on the basis of Exhibit "D". Services and reimbursable expenses of special consultants will be approved by ENGINEER, but shall be paid directly by ENGINEER. At this time, the following special consultants are anticipated, and the Limitation of Costs shown below are recommended for budgetary considerations: **Geotechnical \$38,525.00**

Amend Section 5, Paragraph 5.1.5, to read as follows:

5.1.2.4 Resident Project Services. For resident services during construction furnished under Paragraph 2.2.1, on the basis of Exhibit "D" for services rendered by principals and employees assigned to field offices in connection with resident project representation with a Limitation of Cost of **\$135,000.00**

Amend Section 5, Paragraph 5.1.5, to read as follows:

5.1.3 For Reimbursable Expenses. In addition to payments provided for in Paragraphs 5.1.1 and 5.1.2, OWNER shall pay ENGINEER the actual costs of all Reimbursable Expenses incurred in connection with all Basic and Additional Services with a Limitation of Cost of **\$30,070.00**

Amend Section 5, Paragraph 5.1.5, to read as follows:

5.1.5 The estimated cost of Paragraphs 5.1.2, 5.1.3, and 5.1.4, shall have a combined Limitations of Cost in the amount of **\$300,544.43**, which shall not be exceeded without the issuance of a formal change order authorized by the Terrebonne Parish Consolidated Government through its duly authorized President.

IN WITNESS WHEREOF, the parties hereto have affixed their legal hands on this day of _____, 2017.

OWNER:
TERREBONNE PARISH
CONSOLIDATED GOVERNMENT

BY: _____
Gordon E. Dove, Parish President
Terrebonne Parish Consolidated
Government

ENGINEER
GIS ENGINEERING, LLC

BY: _____
Dustin Malbrough
Vice President

WITNESSES:

WITNESSES:



Coastal Design & Infrastructure

2503 Petroleum Drive | Suite 110
Houma, LA 70363
P: (985) 219-1000 | F: (985) 475-7014
www.giseng.com

January 16, 2017

Terrebonne Parish Consolidated Government
Engineering Department
2000 St. Louis Canal Road
Houma, Louisiana 70360

Attention: Ms. Jeanne Bray, Capital Projects Administrator
Subject: Amendment No. 2
Reference: Parish Project No. 16-DRA-25
Petit Caillou Drainage & Resiliency Project

Ms. Bray:

As per TPCG's request, GIS Engineering, LLC (GIS) is pleased to submit this Amendment No. 2 proposal to continue providing Professional Engineering Services to the Terrebonne Parish Consolidated Government (TPCG) for services to be completed on the above referenced project.

PROPOSED COST

GIS proposes to provide the remaining Basic Services on a Lump Sum basis and the remaining Additional Services on a Time & Material as outlined below and in Attachment 1. *(LS fees were calculated using the standard curve formula and based upon the most recent opinion of probable construction cost estimate presented in the Study & Report phase submittal)*

	Orig. Contract	Amend. No. 1	Amend No. 2	Total
BASIC SERVICES – LUMP SUM				
Study & Report Phase	\$ 44,495.00			\$ 44,495.00
Preliminary Design Phase			\$ 134,200.00	\$ 134,200.00
Final Design Phase			\$ 156,600.00	\$ 156,600.00
Bidding & Negotiations Phase			\$ 22,400.00	\$ 22,400.00
Construction Admin Phase			\$ 89,500.00	\$ 89,500.00
ADDITIONAL SERVICES – T&M				
Existing Conditions Gap Analysis	\$ 13,320.00			\$ 13,320.00
Drainage Basin Research & Analysis	\$ 19,730.00			\$ 19,730.00
Engineering Survey Coordination	\$ 2,700.00			\$ 2,700.00
Survey Subcontractor	\$ 17,250.00		\$ (8,855.57)	\$ 8,394.43
Phase 1 ESA		\$ 5,700		\$ 5,700.00
Permitting/Permitting Coordination			\$ 30,575.00	\$ 30,575.00
Topographic/Hydrographic Surveys			\$ 12,730.00	\$ 12,730.00
Geotechnical Engineering Coordination			\$ 3,800.00	\$ 3,800.00
Geotechnical Engineer Subcontractor			\$ 38,525.00	\$ 38,525.00
Resident Project Representation*			\$ 135,000.00	\$ 135,000.00
Other Direct & Reimbursable Expenses	\$ 2,500.00		\$ 27,570.00	\$ 30,070.00
TOTAL ENGINEERING SERVICES	\$ 99,995.00	\$ 5,700.00	\$ 642,044.43	\$ 747,739.43

*Based on 180 Working Days for Construction

*Based on 1 Full Time Owner Project Rep @ 10hrs/day

CONTRACT AND TERMS

By submitting this proposal, GIS affirms that we are willing to continue performing our professional engineering services in accordance with the terms and conditions of our existing contract with TPCG, dated May 31, 2016.

We appreciate the opportunity to continue working with you on these important drainage projects. If you have any questions or require any additional information, please contact me at 985-219-1000.

Sincerely,



Dustin M. Malbrough, P.E.
Division Manager
GIS Engineering, LLC

DMM:jkf
Attachment

Coastal Design & Infrastructure.

Houma, LA 70363



ENGINEERING SERVICES - COST ESTIMATE

39130-1040	ADDITIONAL SERVICES (A-S)		
0600	Permit Application / Permitt Coordination		\$ 30,575.00
0700	Topo / Hydro Surveying		\$ 12,730.00
0800	Geotech Coordination		\$ 3,800.00
0800	Geotech Subcontractor		\$ 38,525.00
0900	Resident Project Representation		\$ 135,000.00
1000	ODCs & Reimbursable Expenses		\$ 27,570.00
		TOTAL A-S	\$ 248,200.00
		ENGINEERING TOTAL	\$ 650,900.00

GIS Project No.:	39130-1022 and 39130-1023 (AMENDMENT No. 2)
Client:	Terrebonne Parish Consolidated Government
Project Name:	Petit Caillou
Project Location:	Terrebonne Parish
Project Services:	Planning, Permitting, Engineering, Design, Construction Administration
Project Type:	Additional Services

Coastal Design & Infrastructure
2503 Petroleum Drive | Suite 110
Houma, LA 70363
O: (985) 219-1000 | F: (985) 475-7014



2.1 ADDITIONAL SERVICES ESTIMATE

SCOPE ITEM	DESCRIPTION	Principal	Project Manager III	Professional Engineer III	Sr. Environmental Scientist	Civil/Structural Engineer	Engineer Intern I	CADD Tech IV	Survey Party Chief	Survey Crew (3-Man)	Resident Project Representative II	Administrative Assistant	TOTAL
		\$ 225.00	\$ 175.00	\$ 150.00	\$ 150.00	\$ 100.00	\$ 85.00	\$ 100.00	\$ 85.00	\$ 150.00	\$ 75.00	\$ 60.00	
2.1.1	Permitting/Permit Coordination												
	1 Attend Meetings with authorizing agencies	8	8		8							8	32
	2 Information Compilation		5		12		24	4				2	47
	3 Analysis, Permit Application and Submittal		15		12		24	8				8	67
	4 Coordination & Response to Agency Comments	2	8		20		40	8				8	86
	5 DOTD Permit		8				21						29
	Sub-Total MHs	10	44	0	52	0	109	20	0	0	0	26	261
	Sub-Total Cost	\$ 2,250.00	\$ 7,700.00	\$ -	\$ 7,800.00	\$ -	\$ 9,265.00	\$ 2,000.00	\$ -	\$ -	\$ -	\$ 1,560.00	\$ 30,575.00
2.1.2	Topographic/Hydrographic Surveys												
	1 Survey Coordination & Field survey data collection		4	8					4	45		4	61
	2 Survey Data Processing		4	8				16					28
	Sub-Total MHs	0	8	16	0	0	0	16	4	45	0	4	93
	Sub-Total Cost	\$ -	\$ 1,400.00	\$ 2,400.00	\$ -	\$ -	\$ -	\$ 1,600.00	\$ 340.00	\$ 6,750.00	\$ -	\$ 240.00	\$ 12,730.00
2.1.3	Geotechnical Coordination												
	1 Coordinate with geotechnical subcontractor regarding scope, data gathering and analysis		5	8		10	5					5	33
	Sub-Total MHs	0	5	8	0	10	5	0	0	0	0	5	33
	Sub-Total Cost	\$ -	\$ 875.00	\$ 1,200.00	\$ -	\$ 1,000.00	\$ 425.00	\$ -	\$ -	\$ -	\$ -	\$ 300.00	\$ 3,800.00
2.1.4	Construction Oversight & Reporting												
	1 Resident Project Representation										1800		0
	Sub-Total MHs	0	0	0	0	0	0	0	0	0	1800	0	1800
	Sub-Total Cost	\$ -	\$ -	\$ -	\$ -	\$ -	\$ -	\$ -	\$ -	\$ -	\$ 135,000.00	\$ -	\$ 135,000.00
	TOTAL MHs	10	57	24	52	10	114	36	4	45	1800	35	2187
	TOTAL COST	\$ 2,250.00	\$ 9,975.00	\$ 3,600.00	\$ 7,800.00	\$ 1,000.00	\$ 9,690.00	\$ 3,600.00	\$ 340.00	\$ 6,750.00	\$ 135,000.00	\$ 2,100.00	\$ 182,105.00

2.2 REIMBURSABLE EXPENSES

SCOPE ITEM	DESCRIPTION	Cumulative Rate	Charged By	Surveying Subcontractor	Geotechnical Subcontractor	GPS (days)	Boat (days)	VEHICLE (days)	CAMERA (days)	REPRODUCTION	ODC'S	TOTAL
2.2	REIMBURSABLE EXPENSES											
2.2.1	Subcontractors											
2.2.2	Geotechnical	1 \$ 33,500.00	LS		\$ 38,525.00							\$ 38,525.00
	Sub-Total Cost			\$ -	\$ -	\$ 40,775.00					\$ -	\$ 38,525.00
2.2.3	Other Direct Cost											
	Reproduction	1 \$ 3,500.00	LS							\$ 3,500.00		\$ 3,500.00
	Mileage	1 \$ 3,000.00	LS							\$ 3,000.00		\$ 3,000.00
	Vehicle	185 \$ 70.00	Day							\$ 12,950.00		\$ 12,950.00
	Camera	180 \$ 20.00	Day							\$ 3,600.00		\$ 3,600.00
	Other Direct & Reimbursable Expenses	1								\$ -		\$ -
	Sub-Total Cost			\$ -	\$ -	\$ -	\$ -	\$ -	\$ -	\$ 23,050.00		\$ 23,050.00
2.2.4	Survey Direct Cost and Material											
	Survey GPS (RTK)	4 \$ 500.00	Day							\$ 2,000.00		\$ 2,000.00
	Survey Hypack Data Collection & Nav.	2 \$ 300.00	Day							\$ 600.00		\$ 600.00
	Survey Boats (Non motored)	3 \$ 30.00	Day							\$ 90.00		\$ 90.00
	Survey Boats (Motor)	2 \$ 500.00	Day							\$ 1,000.00		\$ 1,000.00
	Survey Materials	1 \$ 550.00	LS							\$ 550.00		\$ 550.00
	Survey Vehicle	4 \$ 70.00	Day							\$ 280.00		\$ 280.00
	Sub-Total Cost			\$ -	\$ -	\$ -	\$ -	\$ -	\$ -	\$ 4,520.00		\$ 4,520.00
	Total Cost											\$ 66,095.00

SCOPE ITEM	DESCRIPTION	1	2	3	4	5	TOTAL
	Sub-Total Cost	\$ 30,575.00	\$ 12,730.00	\$ 3,800.00	\$ 135,000.00	\$ 66,095.00	\$ 248,200.00

SUMMARY OF ENGINEERING SERVICES	
BASIC SERVICES	\$ 402,700.00
ADDITIONAL SERVICES	\$ 182,105.00
REIMBURSIBLE SERVICES	\$ 66,095.00
TOTAL ENGINEERING SERVICES	\$ 650,900.00

Category Number:
Item Number: 13.



Monday, January 23, 2017

Item Title:

Amend 01 - Chacahoula/Gibson Drainage

Item Summary:

RESOLUTION: Providing approval of Amendment No. 1 to the Engineering Agreement for Parish Project No. **16-DRA-26, Chacahoula/Gibson Drainage Project**, Terrebonne Parish, Louisiana.

ATTACHMENTS:

Description	Upload Date	Type
Executive Summary	1/19/2017	Executive Summary
Resolution	1/19/2017	Resolution
Backup Material	1/19/2017	Backup Material



EXECUTIVE SUMMARY

(REQUIRED FOR ALL SUBMISSIONS)

PROJECT TITLE	
16-DRA-26	Chacahoula/Gibson Bayou Black Basin

PROJECT SUMMARY (200 WORDS OR LESS)
To provide engineering services for the Chacahoula/Gibson Drainage Project

PROJECT PURPOSE & BENEFITS (150 WORDS OR LESS)
The purpose of this amendment is to provide engineering services for the Chacahoula/Gibson Drainage Project

TOTAL EXPENDITURE				
\$812,540.00				
AMOUNT SHOWN ABOVE IS: (CIRCLE ONE)				
ACTUAL			ESTIMATED	
IS PROJECTALREADY BUDGETED: (CIRCLE ONE)				
N/A	NO	YES	IF YES AMOUNT BUDGETED:	N/A

COUNCIL DISTRICT(S) IMPACTED (CIRCLE ONE)									
PARISHWIDE	1	<u>2</u>	3	4	5	6	7	8	9

Jeanne P. Bray

01/19/2017

Signature

Date

OFFERED BY:
SECONDED BY:

RESOLUTION

A resolution providing approval of Amendment No. 1 to the Engineering Agreement for Parish Project No. **16-DRA-26, Chacahoula/Gibson Drainage Project**, Terrebonne Parish, Louisiana.

WHEREAS, the Terrebonne Parish Consolidated Government did enter into an original engineering agreement with All South Consulting Engineers, L.L.C. dated May 31, 2016, recordation number 1508194, for the Chacahoula/Gibson Drainage Project identified as Parish Project 16-DRA-26, and

WHEREAS, the Engineering Agreement between OWNER and ENGINEER provides for certain limitations for Basic Services and specific Additional Services, and

WHEREAS, the Study and Report Phase was approved in the original engineering agreement, and

WHEREAS, TPCG is desirous of continuing with the design of the Chacahoula/Gibson Drainage Project, and

WHEREAS, GIS requested an amendment to their existing contract to provide services to continue with the design of the project, and

WHEREAS, the Engineer must receive written authorization from TPCG before beginning the design of any phase of work, and

WHEREAS, the TPCG is desirous of having these services continued so that there is a need for additional funds to be added to the contract, and

WHEREAS, this above work will increase the basic services section of the contract by \$605,495.00 and the additional services section by \$307,040.00.

NOW, THEREFORE BE IT RESOLVED that the Terrebonne Parish Council, on behalf of the Terrebonne Parish Consolidated Government, does hereby approve this Amendment No. 1 to the Engineering Agreement for an increase of \$605,495.00 in Basic Services and \$307,040.00 in additional services, and authorizes Parish President Gordon E. Dove to execute this Amendment No. 1 to the Engineering Agreement for the Chacahoula/Gibson Drainage Project Parish Project No. 16-DRA-26, with GIS Engineering, LLC, and

BE IT FURTHER RESOLVED that a certified copy of the resolution be forwarded to the Engineer, GIS Engineering, LLC.

THERE WAS RECORDED:

YEAS:
NAYS:
NOT VOTING:
ABSENT

And the Chairman declared the resolution adopted on this _____ day of _____, 2017.

* * * * *

I, VENITA H. CHAUVIN, Clerk of the Terrebonne Parish Council, Houma, Louisiana, do hereby certify that the foregoing is a true and correct copy of the RESOLUTION adopted by the Terrebonne Parish Council on _____, 2017, at which meeting a quorum was present.

GIVEN UNDER MY OFFICIAL SIGNATURE AND SEAL OF OFFICE THIS _____ DAY OF _____, 2017.

VENITA H. CHAUVIN, CLERK
TERREBONNE PARISH COUNCIL

**AMENDMENT NO. 1
TO
ENGINEERING AGREEMENT**

THIS AMENDMENT NO. 1, hereafter sometimes referred to as "AGREEMENT", made and entered into this _____ day of _____, 2017;

BY AND BETWEEN:

TERREBONNE PARISH CONSOLIDATED GOVERNMENT, (TPCG), a political subdivision of the State of Louisiana, represented herein by its duly authorized President, Gordon E. Dove (hereafter sometimes referred to as "OWNER"), and

GIS ENGINEERING, LLC, represented herein by Dustin Malbrough, duly authorized Principal (hereafter sometimes referred to as "ENGINEER"):

is a revision pursuant to 5.1.1 (Basic Services) and 5.1.2 (Additional Services) to the ENGINEERING AGREEMENT dated May 31, 2016, for professional engineering services between the OWNER and ENGINEER.

WITNESSED:

WHEREAS, the Terrebonne Parish Consolidated Government did enter into an original engineering contract dated May 31, 2016, to the entitled **Chacahoula/Gibson Drainage Project**, identified as **Parish Project No. 16-DRA-26**, and

WHEREAS, the Engineering Agreement between OWNER and ENGINEER provides for certain limitations for Basic Services and specific Additional Services, and

WHEREAS, the Study and Report Phase was approved in the original engineering agreement, and

WHEREAS, TPCG is desirous of continuing with the design of the Chacahoula/Gibson Drainage Project, and

WHEREAS, GIS requested an amendment to their existing contract to provide services to continue with the design of the project, and

WHEREAS, the TPCG is desirous of having these services continued so that there is a need for additional funds to be added to the contract for an increase in the upset limit for these services, and

NOW THEREFORE, be it understood and agreed by the parties hereto amend the contract as follows:

Amend Section 5, Paragraph 5.1.1, to read as follows:

5.1.1 For Basic Services. OWNER shall pay ENGINEER for Basic Services rendered under Section 1 (as amended and supplemented by Exhibit "A", "Further Description of Basic Engineering Services and Related Matters") as follows:

Study and Report - \$44,495.00
Basic Services - \$605,495.00

Written authorization from OWNER must be obtain before beginning the design of any phase of work.

Amend Section 5, Paragraph 5.1.2.1, to read as follows:

5.1.2.1 General. For Additional Services and Reimbursable Expenses rendered under Paragraphs 2.1.1 through 2.1.17, inclusive (Except services covered by Paragraph 2.1.7 and services as a consultant or witness under 2.1.16), on the basis of Exhibit "D", "Current Rate Schedule - 2013". At this time the following additional services are anticipated and Estimated Costs shown below are recommended for budgetary considerations.

<u>Description</u>	<u>Current Limit</u>	<u>Increase/Decrease</u>	<u>New Limit</u>
Existing Conditions Gap Analysis	\$13,320.00	\$0.00	\$13,320.00
Drainage Basin Research & Analysis	\$19,730.00	\$0.00	\$19,730.00
Engineering Survey Coordination	\$2,700.00	\$0.00	\$2,700.00
Surveying	\$17,250.00	(\$17,250.00)	\$0.00
Permitting/Permitting Coordination	\$0.00	\$30,190.00	\$30,190.00
Federal Agency Coordination on Elliot Jones PS	\$0.00	\$25,000.00	\$25,000.00
Topographic/Hydrographic Surveys	\$0.00	\$12,730.00	\$12,730.00
Geotechnical Engineering Coordination	\$0.00	\$3,800.00	\$3,800.00
Total	\$53,000.00	\$54,470.00	\$107,470.00

Amend Section 5, Paragraph 5.1.2.2, to reads as follows:

5.1.2.2 Special Consultants. For services and reimbursable expenses incurred for coordination of special consultants employed by ENGINEER pursuant to Paragraph 2.1.1 or 2.1.17, on the basis of Exhibit "D". Services and reimbursable expenses of special consultants will be approved by ENGINEER, but shall be paid directly by ENGINEER. At this time, the following special consultants are anticipated, and the Limitation of Costs shown below are recommended for budgetary considerations: **Geotechnical \$34,500.00**

Amend Section 5, Paragraph 5.1.5, to read as follows:

5.1.2.4 Resident Project Services. For resident services during construction furnished under Paragraph 2.2.1, on the basis of Exhibit "D" for services rendered by principals and employees assigned to field offices in connection with resident project representation with a Limitation of Cost of **\$135,000.00**

Amend Section 5, Paragraph 5.1.5, to read as follows:

5.1.3 For Reimbursable Expenses. In addition to payments provided for in Paragraphs 5.1.1 and 5.1.2, OWNER shall pay ENGINEER the actual costs of all Reimbursable Expenses incurred in connection with all Basic and Additional Services with a Limitation of Cost of **\$30,070.00**

Amend Section 5, Paragraph 5.1.5, to read as follows:

5.1.5 The estimated cost of Paragraphs 5.1.2, 5.1.3, and 5.1.4, shall have a combined Limitations of Cost in the amount of **\$307,040.00**, which shall not be exceeded without the issuance of a formal change order authorized by the Terrebonne Parish Consolidated Government through its duly authorized President.

IN WITNESS WHEREOF, the parties hereto have affixed their legal hands on this day of _____, 2017.

OWNER:
TERREBONNE PARISH
CONSOLIDATED GOVERNMENT

ENGINEER
GIS ENGINEERING, LLC

BY: _____
Gordon E. Dove, Parish President
Terrebonne Parish Consolidated
Government

BY: _____
Dustin Malbrough
Vice President

WITNESSES:

WITNESSES:



Coastal Design & Infrastructure

2503 Petroleum Drive | Suite 110
Houma, LA 70363
P: (985) 219-1000 | F: (985) 475-7014
www.gisyseng.com

January 16, 2017

Terrebonne Parish Consolidated Government
Engineering Department
2000 St. Louis Canal Road
Houma, Louisiana 70360

Attention: Ms. Jeanne Bray, Capital Projects Administrator
Subject: Amendment No. 2
Reference: Parish Project No. 16-DRA-25
Petit Caillou Drainage & Resiliency Project

Ms. Bray:

As per TPCG's request, GIS Engineering, LLC (GIS) is pleased to submit this Amendment No. 2 proposal to continue providing Professional Engineering Services to the Terrebonne Parish Consolidated Government (TPCG) for services to be completed on the above referenced project.

PROPOSED COST

GIS proposes to provide the remaining Basic Services on a Lump Sum basis and the remaining Additional Services on a Time & Material as outlined below and in Attachment 1. *(LS fees were calculated using the standard curve formula and based upon the most recent opinion of probable construction cost estimate presented in the Study & Report phase submittal)*

	Orig. Contract	Amend. No. 1	Amend No. 2	Total
BASIC SERVICES – LUMP SUM				
Study & Report Phase	\$ 44,495.00			\$ 44,495.00
Preliminary Design Phase			\$ 134,200.00	\$ 134,200.00
Final Design Phase			\$ 156,600.00	\$ 156,600.00
Bidding & Negotiations Phase			\$ 22,400.00	\$ 22,400.00
Construction Admin Phase			\$ 89,500.00	\$ 89,500.00
ADDITIONAL SERVICES – T&M				
Existing Conditions Gap Analysis	\$ 13,320.00			\$ 13,320.00
Drainage Basin Research & Analysis	\$ 19,730.00			\$ 19,730.00
Engineering Survey Coordination	\$ 2,700.00			\$ 2,700.00
Survey Subcontractor	\$ 17,250.00		\$ (8,855.57)	\$ 8,394.43
Phase 1 ESA		\$ 5,700		\$ 5,700.00
Permitting/Permitting Coordination			\$ 30,575.00	\$ 30,575.00
Topographic/Hydrographic Surveys			\$ 12,730.00	\$ 12,730.00
Geotechnical Engineering Coordination			\$ 3,800.00	\$ 3,800.00
Geotechnical Engineer Subcontractor			\$ 38,525.00	\$ 38,525.00
Resident Project Representation*			\$ 135,000.00	\$ 135,000.00
Other Direct & Reimbursable Expenses	\$ 2,500.00		\$ 27,570.00	\$ 30,070.00
TOTAL ENGINEERING SERVICES	\$ 99,995.00	\$ 5,700.00	\$ 642,044.43	\$ 747,739.43

*Based on 180 Working Days for Construction

*Based on 1 Full Time Owner Project Rep @ 10hrs/day

CONTRACT AND TERMS

By submitting this proposal, GIS affirms that we are willing to continue performing our professional engineering services in accordance with the terms and conditions of our existing contract with TPCG, dated May 31, 2016.

We appreciate the opportunity to continue working with you on these important drainage projects. If you have any questions or require any additional information, please contact me at 985-219-1000.

Sincerely,



Dustin M. Malbrough, P.E.
Division Manager
GIS Engineering, LLC

DMM:jkf
Attachment

Coastal Design & Infrastructure.

Houma, LA 70363

GIS Project No.:	39130-1022 and 39130-1023 (AMENDMENT No. 2)
Client:	Terrebonne Parish Consolidated Government
Project Name:	Petit Caillou
Project Location:	Terrebonne Parish
Project Services:	Planning, Permitting, Engineering, Design, Construction Administration
Project Type:	Basic & Additional Services

SCOPE ITEM	DESCRIPTION	Total
39130-1039	BASIC SERVICES (B-S)	
A	Study and Report Phase	\$ -
B	Preliminary Design Phase	\$ 134,200.00
C	Final Design Phase	\$ 156,600.00
D	Advertising and Bidding Phase	\$ 22,400.00
E	Construction Phase	\$ 89,500.00
	TOTAL B-S	\$ 402,700.00

39130-1040	ADDITIONAL SERVICES (A-S)		
0600	Permit Application / Permitt Coordination		\$ 30,575.00
0700	Topo / Hydro Surveying		\$ 12,730.00
0800	Geotech Coordination		\$ 3,800.00
0800	Geotech Subcontractor		\$ 38,525.00
0900	Resident Project Representation		\$ 135,000.00
1000	ODCs & Reimbursable Expenses		\$ 27,570.00
		TOTAL A-S	\$ 248,200.00
		ENGINEERING TOTAL	\$ 650,900.00

GIS Project No.:	39130-1022 and 39130-1023 (AMENDMENT No. 2)
Client:	Terrebonne Parish Consolidated Government
Project Name:	Petit Caillou
Project Location:	Terrebonne Parish
Project Services:	Planning, Permitting, Engineering, Design, Construction Administration
Project Type:	Additional Services

Coastal Design & Infrastructure
2503 Petroleum Drive | Suite 110
Houma, LA 70363
O: (985) 219-1000 | F: (985) 475-7014



2.1 ADDITIONAL SERVICES ESTIMATE

SCOPE ITEM	DESCRIPTION	Principal	Project Manager III	Professional Engineer III	Sr. Environmental Scientist	Civil/Structural Engineer	Engineer Intern I	CADD Tech IV	Survey Party Chief	Survey Crew (3-Man)	Resident Project Representative II	Administrative Assistant	TOTAL
		\$ 225.00	\$ 175.00	\$ 150.00	\$ 150.00	\$ 100.00	\$ 85.00	\$ 100.00	\$ 85.00	\$ 150.00	\$ 75.00	\$ 60.00	
2.1.1	Permitting/Permit Coordination												
	1 Attend Meetings with authorizing agencies	8	8		8							8	32
	2 Information Compilation		5		12		24	4				2	47
	3 Analysis, Permit Application and Submittal		15		12		24	8				8	67
	4 Coordination & Response to Agency Comments	2	8		20		40	8				8	86
	5 DOTD Permit		8				21						29
	Sub-Total MHs	10	44	0	52	0	109	20	0	0	0	26	261
	Sub-Total Cost	\$ 2,250.00	\$ 7,700.00	\$ -	\$ 7,800.00	\$ -	\$ 9,265.00	\$ 2,000.00	\$ -	\$ -	\$ -	\$ 1,560.00	\$ 30,575.00
2.1.2	Topographic/Hydrographic Surveys												
	1 Survey Coordination & Field survey data collection		4	8					4	45		4	61
	2 Survey Data Processing		4	8				16					28
	Sub-Total MHs	0	8	16	0	0	0	16	4	45	0	4	93
	Sub-Total Cost	\$ -	\$ 1,400.00	\$ 2,400.00	\$ -	\$ -	\$ -	\$ 1,600.00	\$ 340.00	\$ 6,750.00	\$ -	\$ 240.00	\$ 12,730.00
2.1.3	Geotechnical Coordination												
	1 Coordinate with geotechnical subcontractor regarding scope, data gathering and analysis		5	8		10	5					5	33
	Sub-Total MHs	0	5	8	0	10	5	0	0	0	0	5	33
	Sub-Total Cost	\$ -	\$ 875.00	\$ 1,200.00	\$ -	\$ 1,000.00	\$ 425.00	\$ -	\$ -	\$ -	\$ -	\$ 300.00	\$ 3,800.00
2.1.4	Construction Oversight & Reporting												
	1 Resident Project Representation										1800		0
	Sub-Total MHs	0	0	0	0	0	0	0	0	0	1800	0	1800
	Sub-Total Cost	\$ -	\$ -	\$ -	\$ -	\$ -	\$ -	\$ -	\$ -	\$ -	\$ 135,000.00	\$ -	\$ 135,000.00
	TOTAL MHs	10	57	24	52	10	114	36	4	45	1800	35	2187
	TOTAL COST	\$ 2,250.00	\$ 9,975.00	\$ 3,600.00	\$ 7,800.00	\$ 1,000.00	\$ 9,690.00	\$ 3,600.00	\$ 340.00	\$ 6,750.00	\$ 135,000.00	\$ 2,100.00	\$ 182,105.00

2.2 REIMBURSABLE EXPENSES

2.2 REIMBURSABLE EXPENSES													
SCOPE ITEM	DESCRIPTION	Cumulative Rate	Charged By	Surveying Subcontractor	Geotechnical Subcontractor	GPS (days)	Boat (days)	VEHICLE (days)	CAMERA (days)	REPRODUCTION	ODC'S	TOTAL	
Subcontractors													
2.2.2	Geotechnical	1 \$ 33,500.00	LS		\$ 38,525.00							\$ 38,525.00	
	Sub-Total Cost			\$ -	\$ -	\$ 40,775.00					\$ -	\$ 38,525.00	
Other Direct Cost													
2.2.3	Reproduction	1 \$ 3,500.00	LS							\$ 3,500.00	\$ 3,500.00	\$ 3,500.00	
	Mileage	1 \$ 3,000.00	LS							\$ 3,000.00	\$ 3,000.00	\$ 3,000.00	
	Vehicle	185 \$ 70.00	Day							\$ 12,950.00	\$ 12,950.00	\$ 12,950.00	
	Camera	180 \$ 20.00	Day							\$ 3,600.00	\$ 3,600.00	\$ 3,600.00	
	Other Direct & Reimbursable Expenses	1								\$ -	\$ -	\$ -	
	Sub-Total Cost			\$ -	\$ -	\$ -	\$ -	\$ -	\$ -	\$ 23,050.00	\$ 23,050.00	\$ 23,050.00	
2.2.4	Survey Direct Cost and Material												
	Survey GPS (RTK)	4 \$ 500.00	Day							\$ 2,000.00	\$ 2,000.00	\$ 2,000.00	
	Survey Hypack Data Collection & Nav.	2 \$ 300.00	Day							\$ 600.00	\$ 600.00	\$ 600.00	
	Survey Boats (Non motored)	3 \$ 30.00	Day							\$ 90.00	\$ 90.00	\$ 90.00	
	Survey Boats (Motor)	2 \$ 500.00	Day							\$ 1,000.00	\$ 1,000.00	\$ 1,000.00	
	Survey Materials	1 \$ 550.00	LS							\$ 550.00	\$ 550.00	\$ 550.00	
	Survey Vehicle	4 \$ 70.00	Day							\$ 280.00	\$ 280.00	\$ 280.00	
	Sub-Total Cost			\$ -	\$ -	\$ -	\$ -	\$ -	\$ -	\$ 4,520.00	\$ 4,520.00	\$ 4,520.00	
	Total Cost										\$ 66,095.00	\$ 66,095.00	

TOTAL PROJECT COSTS		1	2	3	4	5	
SCOPE ITEM	DESCRIPTION	PERMITTING/PERMITTING COORDINATION	SURVEYING COORDINATION	GEOTECH COORDINATION	CONSTRUCTION OVERSIGHT	REIMBURSABLE EXPENSES	TOTAL
	Sub-Total Cost	\$ 30,575.00	\$ 12,730.00	\$ 3,800.00	\$ 135,000.00	\$ 66,095.00	\$ 248,200.00

SUMMARY OF ENGINEERING SERVICES	
BASIC SERVICES	\$ 402,700.00
ADDITIONAL SERVICES	\$ 182,105.00
REIMBURSIBLE SERVICES	\$ 66,095.00
TOTAL ENGINEERING SERVICES	\$ 650,900.00